

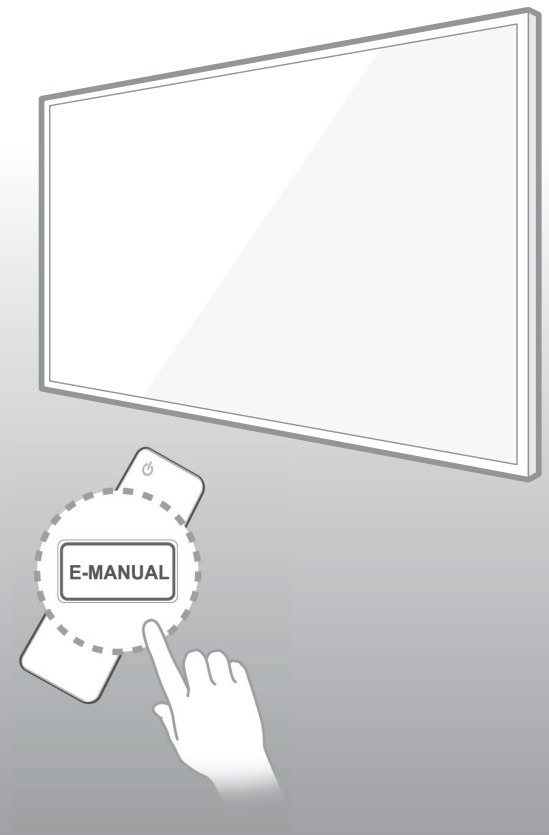

SERIES **4**
4500

LED TV

user manual



Thank you for purchasing this Samsung product.
To receive more complete service, please
register your product at
www.samsung.com/register
Model _____ Serial No. _____

If you have any questions, please call us at 1-800-SAMSUNG (1-800-726-7864) for assistance.
* This Nanum Gothic Eco font is provided by NAVER.

Warning! Important Safety Instructions

(Please read the Safety Instructions before using your TV.)

CAUTION

RISK OF ELECTRIC SHOCK DO NOT OPEN

CAUTION: TO REDUCE THE RISK OF ELECTRIC SHOCK, DO NOT REMOVE COVER (OR BACK). THERE ARE NO USER SERVICEABLE PARTS INSIDE. REFER ALL SERVICING TO QUALIFIED PERSONNEL.



This symbol indicates that high voltage is present inside. It is dangerous to make any kind of contact with any internal part of this product.



This symbol indicates that important literature concerning operation and maintenance has been included with this product.

- The slots and openings in the cabinet and in the back or bottom are provided for necessary ventilation. To ensure reliable operation of this apparatus, and to protect it from overheating, these slots and openings must never be blocked or covered.
 - Do not place this apparatus in a confined space, such as a bookcase, or built-in cabinet, unless proper ventilation is provided.
 - Do not place this apparatus near or over a radiator or heat register, or where it is exposed to direct sunlight.
 - Do not place vessels (vases etc.) containing water on this apparatus, as this can result in a fire or electric shock.
- Do not expose this apparatus to rain or place it near water (near a bathtub, washbowl, kitchen sink, or laundry tub, in a wet basement, or near a swimming pool etc.). If this apparatus accidentally gets wet, unplug it and contact an authorized dealer immediately.
- This apparatus uses batteries. In your community, there might be environmental regulations that require you to dispose of these batteries properly. Please contact your local authorities for disposal or recycling information.
- Do not overload wall outlets, extension cords or adaptors beyond their capacity, since this can result in fire or electric shock.
- Power-supply cords should be placed so that they are not likely to be walked on or pinched by items placed upon or against them. Pay particular attention to cords at the plug end, at wall outlets, and the point where they exit from the appliance.
- To protect this apparatus from a lightning storm, or when it is left unattended and unused for long periods of time, unplug it from the wall outlet and disconnect the antenna or cable system. This will prevent damage to the set due to lightning and power line surges.
- Before connecting the AC power cord to the DC adaptor outlet, make sure the voltage designation of the DC adaptor corresponds to the local electrical supply.
- Never insert anything metallic into the open parts of this apparatus. Doing so may create a danger of electric shock.
- To avoid electric shock, never touch the inside of this apparatus. Only a qualified technician should open this apparatus.

- Make sure to plug the power cord in until it is firmly seated. When unplugging the power cord from a wall outlet, always pull on the power cord's plug. Never unplug by pulling on the power cord. Do not touch the power cord with wet hands.
- If this apparatus does not operate normally - in particular, if there are any unusual sounds or smells coming from it - unplug it immediately and contact an authorized dealer or service center.
- Be sure to pull the power plug out of the outlet if the TV is to remain unused or if you are to leave the house for an extended period of time (especially when children, elderly or disabled people will be left alone in the house).
 - Accumulated dust can cause an electric shock, an electric leakage or a fire by causing the power cord to generate sparks and heat or the insulation to deteriorate.
- Be sure to contact an authorized service center for information if you intend to install your TV in a location with heavy dust, high or low temperatures, high humidity, chemical substances, or where it will operate 24 hours a day such as in an airport, a train station, etc. Failing to do so may lead to serious damage to your TV.
- Use only a properly grounded plug and wall outlet.
 - An improper ground may cause electric shock or equipment damage. (Class I Equipment only.)
- To turn this apparatus off completely, you must disconnect it from the wall outlet. Consequently, the wall outlet and power plug must be readily accessible at all times.
- Do not allow children to hang on the product.
- Store the accessories (battery, etc.) in a location safely out of the reach of children.
- Do not install the product in an unstable location such as a shaky shelf, a slanted floor, or a location exposed to vibration.
- Do not drop or strike the product. If the product is damaged, disconnect the power cord and contact a service center.
- To clean this apparatus, unplug the power cord from the wall outlet and wipe the product using a soft, dry cloth. Do not use any chemicals such as wax, benzene, alcohol, thinners, insecticide, air fresheners, lubricants, or detergent. These chemicals can damage the appearance of the TV or erase the printing on the product.
- Do not expose this apparatus to dripping or splashing.
- Do not dispose of batteries in a fire.
- Do not short-circuit, disassemble, or overheat the batteries.
- There is danger of an explosion if you replace the batteries used in the remote with the wrong type of battery. Replace only with the same or equivalent type.
- **WARNING - TO PREVENT THE SPREAD OF FIRE, KEEP CANDLES OR OTHER ITEMS WITH OPEN FLAMES AWAY FROM THIS PRODUCT AT ALL TIMES.**
- This product contains chemicals known to the State of California to cause cancer and reproductive toxicity.
- Use care when touching the TV after it has been on for some time. Some parts can be warm to the touch.



Internet Security

Samsung takes a number of steps to protect its Internet-compatible Smart TVs against unauthorized incursions and hacking. For example, certain sensitive communications between the TV and the Internet servers are encrypted. In addition, the TV's operating system has adopted controls to prevent the installation of unauthorized applications.

Although we take steps to protect your SmartTV and information, no Internet-connected device or transmission is completely secure. We therefore encourage you to take additional steps to safeguard your TV, secure your Internet connection, and minimize the risk of unauthorized access. These steps are listed below:

- When Samsung releases software updates to improve the security on your TV, you should promptly install these updates. To automatically receive these updates, turn on **"Auto Update"** in the TV's menu (**Support > Software Update > Auto Update**). When an update is available, a popup message appears on the TV screen. Accept the software download and update by selecting YES when prompted. Take steps to secure your wireless router and network. Your router's manual should provide additional details about how to implement the following measures:
 - Secure your wireless router's management settings with a unique password to prevent unauthorized changes to security related settings.
 - Implement standard encryption (e.g., WPA2 encryption) on your wireless router to secure your wireless network signal.
 - Secure access to your wireless network with a hard-to-guess password.
 - Confirm your router's firewall setting is enabled (if so equipped).
 - Make sure all your Internet connected devices are behind your network's firewall.
 - If your router or modem has a standby mode button, use it to disconnect your home network from the Internet when it is not in use.
- Use strong passwords for all your Internet accounts (Netflix, Facebook, Skype, etc.). If your TV has a camera, recess the camera into the TV's bezel when it is not in use. Recessing the camera makes it inoperative.
- If any unexpected messages appear on your TV screen requesting permission to link a device or enable a remote session, do NOT accept.
- Do not visit suspicious web sites and do not install any suspicious programs. We recommend users install only those authorized apps provided by Samsung through Samsung Smart Hub.

Figures and illustrations in this User Manual are provided for reference only and may differ from the actual product appearance. Product design and specifications may change without notice.

Features of your new TV

SMART HUB

Your TV features Smart Hub, a multi-purpose entertainment and family center. With Smart Hub, you can surf the web and download applications.

Press the  button to open the **First Screen**, and then select the Panel icon. The TV displays the Panel screen. Choose a service using the icons displayed in the top part of the screen.

Smart Hub services and functionality include:

SAMSUNG APPS: Samsung Apps offers an extensive collection of free and for-pay news, sports, weather, and gaming content you can download directly to and enjoy on your TV.

On TV: View a listing of programs that are currently airing or are scheduled to air. Select a program to watch.

e-Manual

Provides a detailed, on-screen user's manual built into your TV (page 14).

Device Manager

Use the TV features with a USB keyboard and mouse.

Screen Mirroring

Displays mobile device screens on the TV using a wireless connection.

Contents

01. Turning on the TV and Cabling

- 7 Turning on and Controlling the TV
- 7 Arrange the cables using the Cable Holder

02. Using the Remote Control

- 8 Using the Remote Control
- 10 Switching Between Video Sources
- 10 Using the Remote Control to Control External Devices
- 10 Connecting the IR Extender Cable
- 11 Setting Up the Universal Remote Control

03. Smart Hub

04. Using the e-Manual

- 14 Launching the e-Manual
- 14 Additional e-Manual Features
- 15 Updating the e-Manual to the Latest Version

05. Troubleshooting and Maintenance

- 16 Troubleshooting
- 18 Network Troubleshooting
- 21 Getting Remote Support
- 21 Caring for the TV

06. Specifications, wall mounting, and other information

- 22 Specifications
- 23 Dimensions
- 24 Licenses
- 25 Mounting the TV on a Wall Using the Wall Mount Kit (Optional)
- 26 Providing Proper Ventilation for Your TV
- 27 Securing the TV to the Wall
- 28 Warranty Information
- 29 SAMSUNG BRAND PRODUCTS

01. Turning on the TV and Cabling

Turning on and Controlling the TV

You can turn on the TV using the Remote Control or the TV's Controller, a small joystick-like button on the back lower-left corner of the TV. You can also use the TV's Controller to operate the TV without the Remote Control.

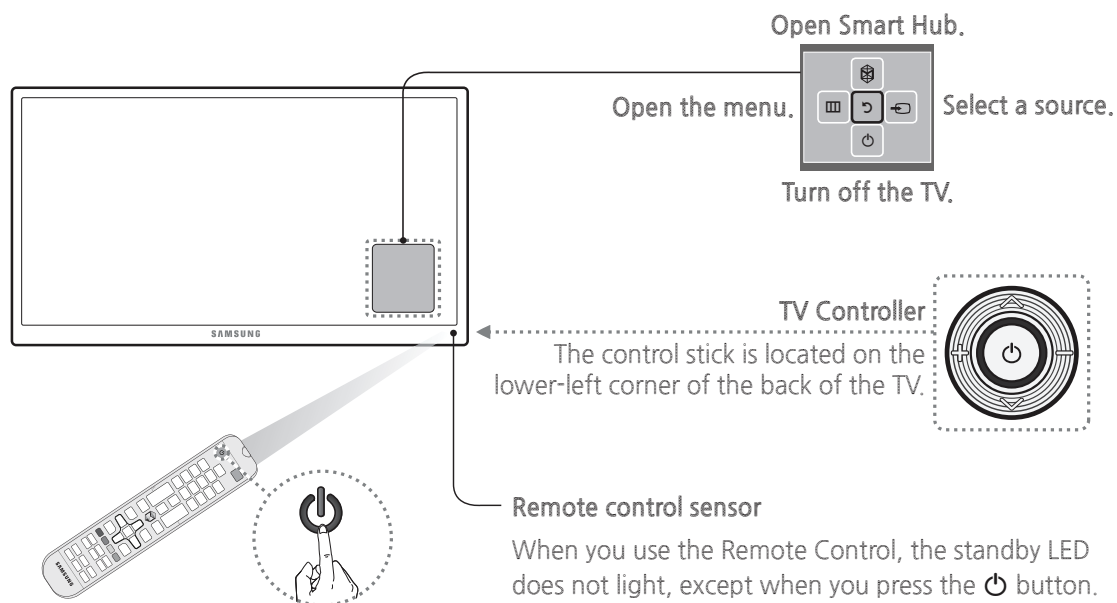

Arrange the cables using the Cable Holder

< For 24 inch model >

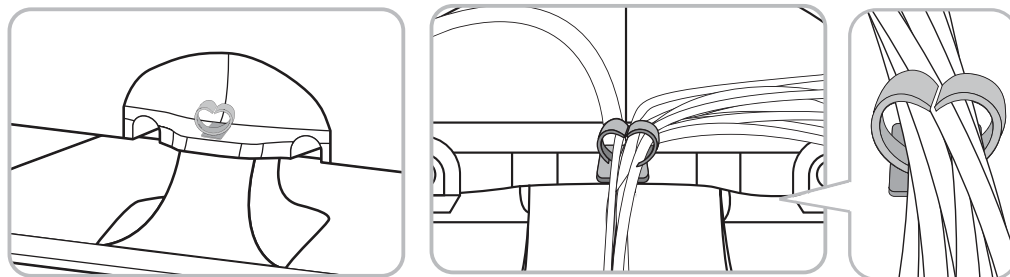

< For 28 inch model >

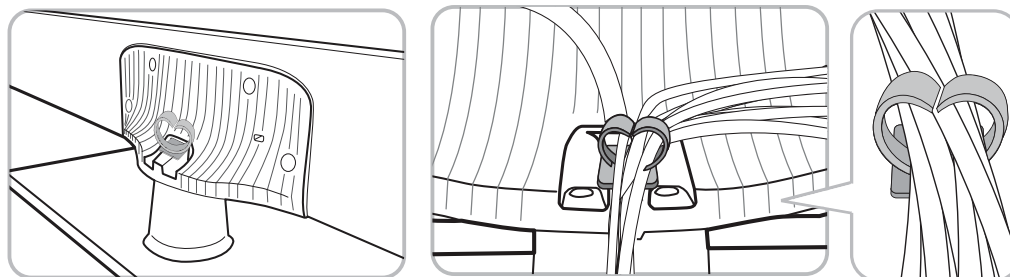

02.Using the Remote Control

Using the Remote Control

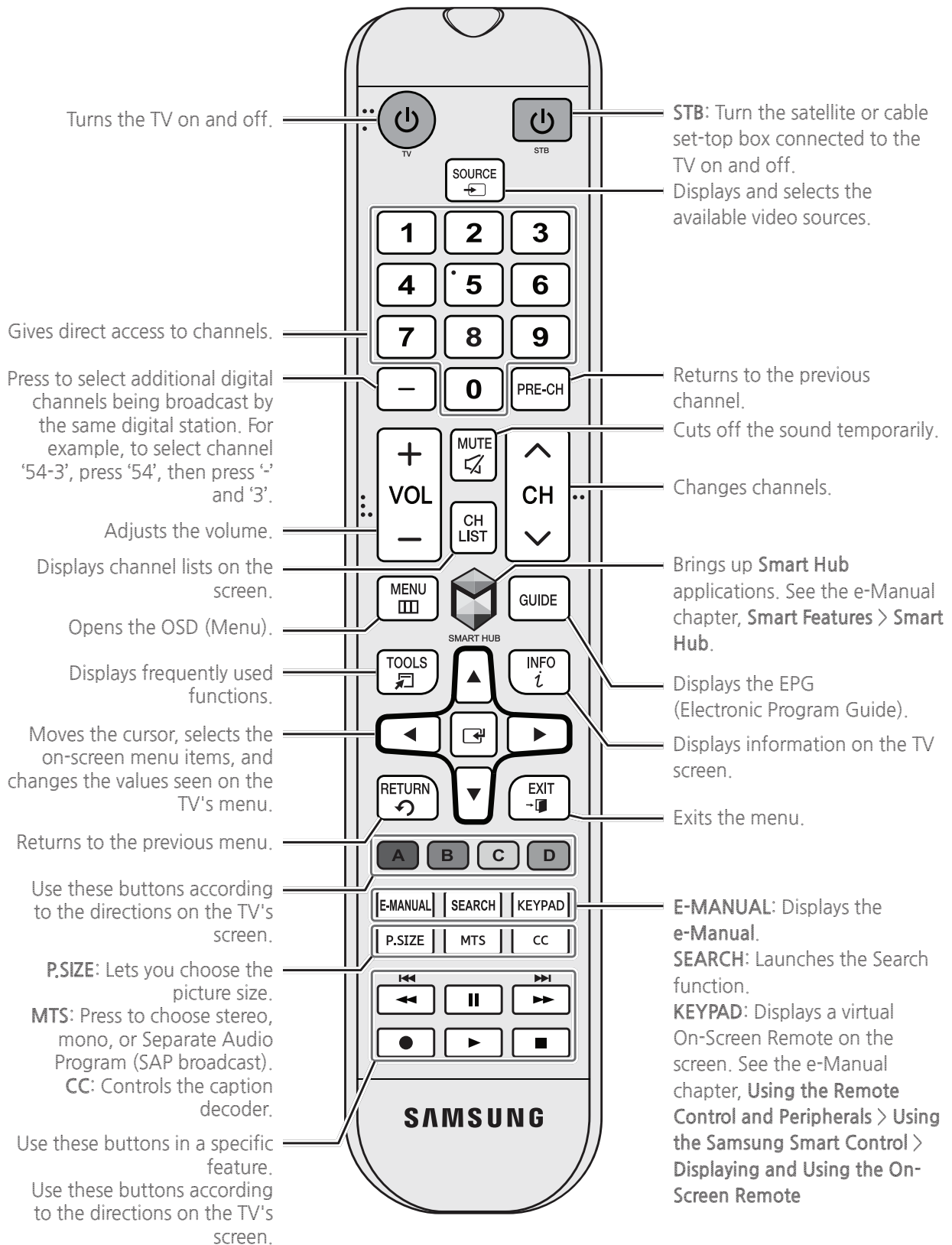

Installing Batteries into the Remote Control

Match the polarity of the batteries to the symbols in the battery compartment.

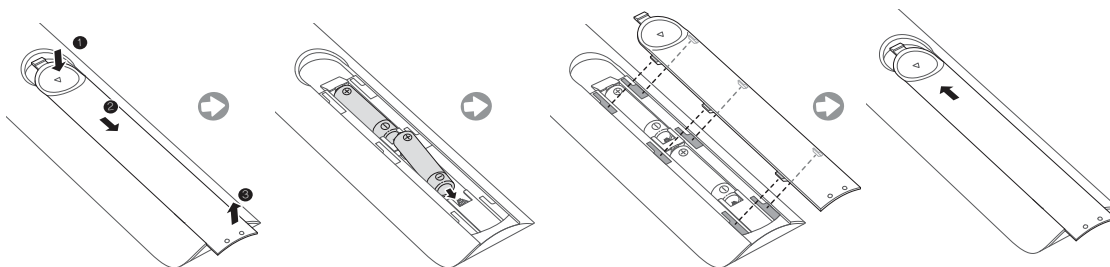

NOTE

- Use the remote control within 23 feet of the TV.
- Bright light may affect the performance of the remote control. Avoid using near bright fluorescent lights or neon signs.
- The color and shape may vary depending on the model.

Switching Between Video Sources

Press the **SOURCE** button to switch between external devices connected to the TV. For example, to switch to a game console connected to the second HDMI connector, press the **SOURCE** button. The Source List appears across the top of the screen. From the **Source** list, select **HDMI2**.

- The connector names may vary depending on the product.

Using the Remote Control to Control External Devices

MENU > System > Universal Remote Setup

The universal remote control feature lets you control cable boxes, Blu-ray players, home theaters, and other third-party external devices connected to the TV using the TV's remote control. For each external device you want to control, you must run the universal remote set up process. The first step in the process is connecting the IR extender cable (included) to the TV and positioning the transmitter end of the cable in front of the device you want to control.

Connecting the IR Extender Cable

- The color and design of the IR extender cable may vary depending on the model.

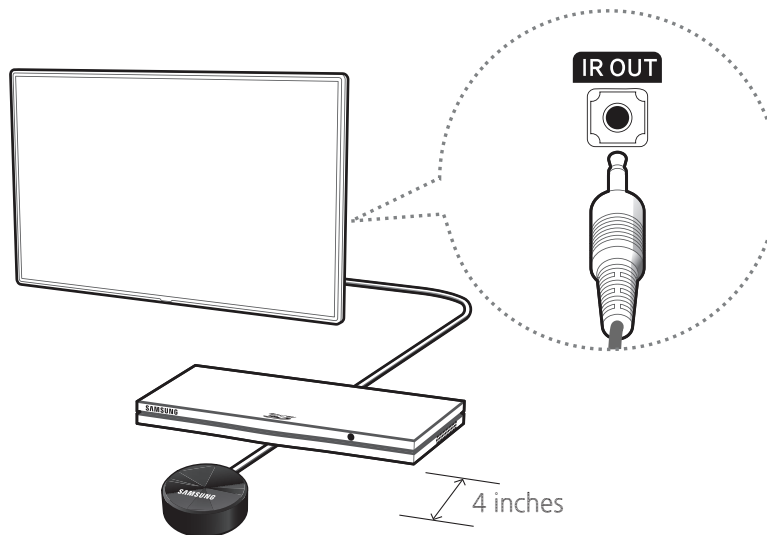

To begin the universal remote set up process, connect the IR extender cable (included) to the TV's IR output connector as shown in the diagram, and then position the transmitter end within 4 inches (10 cm) of the external device's remote control sensor, pointing in the direction of the sensor.

There can be no obstacles between the transmitter end of the IR extender cable and the external device. Any obstacles will interfere with the transmission of the remote control signals.

Setting Up the Universal Remote Control

- If you want to control a set-top-box, you need to have your zip code and your cable provider's name and location on hand before you begin. If you want to control a Blu-ray player or home theater, you need the manufacturer's name and model number.
1. Turn on the external device you want to control with the universal remote function.
 2. Press the **SOURCE** button on your remote to bring up the **Source** screen.
 3. Select the **Universal Remote Setup** icon.
 - You can also start Universal Remote Setup through the TV's menu. Navigate to **System > Universal Remote Setup**.
 4. The TV checks if the IR extender cable is connected. If it confirms the connection, press the  button.
 5. Select the type of device you want to control - set-top-box, Blu-ray player, or home theater.
 6. Follow the directions on the screen to complete the set up and register the device. The directions will be different, depending on the device you want to control.
 7. Once set up is complete and you have confirmed that you can use the TV remote to control the device, disconnect the IR extender cable from the TV and set it aside. You can now control the device directly with your remote.

Controlling an External Device with the TV Remote

During the universal remote set up process, the TV registers the connector (source) the external device is connected to. To control a registered external device with your TV's remote, select the external device on the Source List.

1. Press the **SOURCE** button on your remote.
2. Select the source the device is connected to (HDMI1, HDMI2, etc.).
3. Control the device with the remote. For example, if the device is a set-top-box, press the channel buttons on the remote to change the channel.

For information on additional functions, see "Controlling External Devices with the TV Remote - Using the Universal Remote" in the e-Manual.

03. Smart Hub

Smart Hub is the control center of the TV. Through Smart Hub you can view TV program schedules and select shows to watch, download and install apps.

Smart Hub has 2 main panels: **SAMSUNG APPS** and **On TV**.

To move from panel to panel, select one of the icons at the top of the screen. You can also press the left or right button to display the previous or next panel. Each panel gives you access to additional screens. To open the additional screens, select items on the panel or select an icon or hotspot on the screen.

- The TV must be connected to the Internet to access Smart Hub.

SAMSUNG APPS Panel

The **SAMSUNG APPS** panel displays a variety of free and for pay news, sports, weather, and gaming apps.

The Samsung Apps panel has a number of sub-panels including **Most Popular**, **What's new**, and **Categories**. Default apps install automatically when Smart Hub is first launched. The default apps may differ depending on your region. Most apps listed on the **SAMSUNG APPS** panel are free, but some apps require a fee. To download these, you must have a Samsung Account with a registered credit card.

SAMSUNG APPS Panel Functions

Move the focus to an app, and then press and hold the  button. An Options drop down list appears with the following functions.

- **Move:** Relocates an app on the screen.
- **Delete:** Removes a selected app from your TV.
- **Multi Delete:** Removes multiple apps from the TV.
- **View Details:** Displays detailed information about a selected app.
- **Change View:** Changes how the apps are sorted on the screen, by Custom view or Most Played.
- **Lock/Unlock:** Locks or unlocks apps. Locked apps cannot be accessed.
- **Update Apps:** Displays a list of apps that have updates available. You can select which apps to update.

The **SAMSUNG APPS** Panel functions are context-sensitive. The functions that appear may differ depending on the app you select.

Downloading and Installing an App

1. On the **SAMSUNG APPS** panel, select **Most Popular**, **What's new**, or **Categories**.
2. Move the focus to an app, and then press and hold the  button. When the Options drop down list appears, select **Download** from the list. If the app is free, the app you selected is installed on the TV. If the app is not free, follow the directions on the screen to pay for and download the app.

On TV Panel

On TV displays your current program live in a small window, a list of recommended programs currently on other channels, and a list of recommended programs that will air later. Use these lists to change the channel, view more information about recommended programs running later, including how much time is left until they air. You can also set up a **Schedule Viewing** of a program that hasn't aired yet.

To view a program recommended by **On TV**, select the image.

The **On TV** panel has the following main subpanels:

- **Guide**: Displays the program schedule of each digital channel. You can check the program schedule and set up a Schedule Viewing.
- **Timeline View**: Displays program recommendations for different times of the day.
- **Trending**: Displays what is the most trendy or popular content on Twitter. You can set up a **Schedule Viewing** to view the content.

On TV Panel Functions

Move the focus to a program, and then press and hold the  button. An **Options** drop down list appears with the following functions.

- **View details**: Displays detailed information about the selected program.
- **Schedule**: Sets up a **Schedule** for the selected program.

04. Using the e-Manual

Launching the e-Manual

MENU > Support > e-Manual

The embedded e-manual contains information about your TV's key features.

- Alternatively, you can download a copy of the e-manual from Samsung's website, and read it on your computer or print it out.
- Words in yellow indicate a menu item and bold words in white indicate remote control buttons.
- Arrows are used to indicate the menu path. (Example: **MENU > Picture > Picture Mode**)

1. Press the **E-MANUAL** button. You can also select **Support > e-Manual** in the TV's menu.
2. Select a category from the left side of the screen. Once a selection has been made, the contents of the selected category appear on the right side of the screen.
3. Select an item from the list. This opens the e-manual on the corresponding page.

If a description doesn't fit on a single screen...

- Position the focus on the page to display  /  on the screen. Press the  or  buttons to scroll the page up and down.

Additional e-Manual Features

Loading Pages using Keywords

Select **Search** to bring up the search screen. Enter a search term, and then select **Done**. Select an item from the search results to load the corresponding page.

Loading Pages from the Index Page

Select **Index** to bring up the index screen. Select a keyword from the list to navigate to the relevant page.

Using History to Load Previously Read Pages

Select **Opened page**. A list of previously read pages is shown. Select a page. The e-Manual jumps to the selected page.

Accessing the Menu from the e-Manual

Select  (Try Now) from the right side of a feature-description page to access the corresponding menu item and try out the feature right away. If you want to read the e-Manual entry on a specific screen menu feature:

- Press the **E-MANUAL** button to load the corresponding e-Manual page.
- The e-Manual cannot be accessed from some menu screens.

Loading Reference Pages

Select  (Link) from the right side of a feature-description page to access the corresponding reference page.

Updating the e-Manual to the Latest Version

You can update the e-Manual in the same way you update apps.

1. Select **e-Manual** item in the **SAMSUNG APPS** screen.
2. Press and hold the  button. A pop-up menu appears.
3. Select **Update Apps** from the pop-up menu. A pop-up window appears.
4. Select **e-Manual** in the popup window, and then select **Update**.

Configuring Auto Update

MENU > Smart Hub > Apps Settings

To update the e-manual automatically, navigate to the **Smart Hub > Apps Settings** menu and set the **Auto Update** option to **On**. The e-manual is updated automatically when an update becomes available.

05. Troubleshooting and Maintenance

Troubleshooting

If the TV seems to have a problem, first review this list of possible problems and solutions. Also, review the Troubleshooting Section in the e-Manual. If none of the troubleshooting tips apply, visit www.samsung.com/support or call Samsung Customer Service at 1-800-SAMSUNG (1-800-726-7864).





Issues	Solutions and Explanations
Flickering and Dimming	Try disabling some of the TV's energy efficiency features. Disable Energy Saving (System > Eco Solution > Energy Saving) and check again.
Screen Color is Not Correct	Run a Self Diagnosis Picture Test (Support > Self Diagnosis > Picture Test). If the picture problem is caused by the TV, the problem should be visible in the Picture Test. If the problem is not visible, next confirm that the TV's video input ports are connected to the correct external video device output ports and that none of the connections are loose. Finally, if possible, test your external video devices by connecting them to another TV.
Screen Brightness	Adjust the following settings: Navigate to Picture and adjust Backlight , Contrast , Brightness , Sharpness , Color , Tint (G/R) and other picture quality adjustment settings.
Unwanted Powering Off	Check if Sleep Timer (System > Time > Sleep Timer) has been enabled. Sleep Timer automatically turns off the TV after an amount of time that you select. If the Sleep Timer has not been enabled, see if No Signal Power Off (System > Eco Solution > No Signal Power Off) or Auto Power Off (System > Eco Solution > Auto Power Off) has been enabled. No Signal Power Off turns off the TV if no signal has been received by the TV for a specified period time. Auto Power Off turns off the TV if there has been no user input in four hours.
Trouble Powering On	Confirm that the power cord is connected and that the remote has live batteries and is functioning correctly. If the power cord is connected properly and the remote control is operating normally, there might be a problem with the antenna cable connection or the cable/satellite box might not be turned on. Check the antenna connection or turn on the cable/satellite box.
Stand Assembly	If you have any trouble assembling the stand, review the stand assembly instruction in the Quick Start Guide.
Cannot Find a Channel	Re-run Setup (Go to MENU > System > Setup) or run Auto Program . (Go to MENU > Broadcasting > Auto Program).

- For detailed troubleshooting information, watch the troubleshooting videos at www.samsung.com/spsn.

Issues	Solutions and Explanations
The TV won't turn on.	<p>Make sure the AC power cord is securely plugged in to the wall outlet and the TV.</p> <p>Make sure the wall outlet is working.</p> <p>Try pressing the  button on the TV to make sure the problem is not the remote. If the TV turns on, refer to "Remote control does not work" below.</p>
There is no picture/video.	<p>Check the cable connections. Remove and reconnect all cables connected to the TV and external devices.</p> <p>Set the video outputs of your external devices (Cable/Sat Box, DVD, Blu-ray etc) to match the TV's input connections. For example, if an external device's output is HDMI, it should be connected to an HDMI input on the TV.</p> <p>Make sure your connected devices are powered on.</p> <p>Be sure to select the correct input source.</p> <p>Reboot the connected device by unplugging it, and then reconnecting the device's power cable.</p>
The remote control does not work.	<p>Replace the remote control batteries. Make sure the batteries are installed with their poles (+/-) in the correct direction.</p> <p>Clean the sensor's transmission window on the remote.</p> <p>Try pointing the remote directly at the TV from 5~6 feet away.</p>
The cable/set top box remote control doesn't turn the TV on or off or adjust the volume.	<p>Program the Cable/Set remote control to operate the TV. Refer to the Cable/Set-Top-Box user manual for the SAMSUNG TV code.</p>

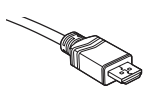
- This TFT LED panel is made up of sub pixels which require sophisticated technology to produce. There may be, however, a few bright or dark pixels on the screen. These pixels will have no impact on the performance of the product.
- To keep your TV in optimum condition, upgrade to the latest software. Use the Update Now or Auto Update functions on the TV's menu (Screen **MENU** > **Support** > **Software Update** > **Update now** or Screen **MENU** > **Support** > **Software Update** > **Auto Update**).

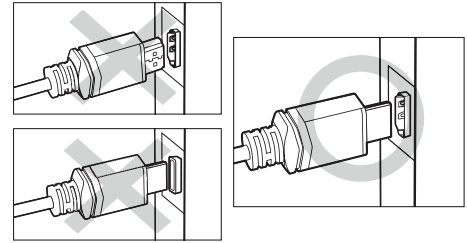
Make sure you have the correct cable before plugging it in. Illustrations of common plugs and ports are shown below.

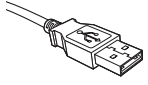
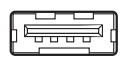
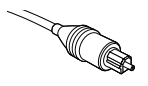
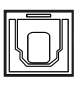
	Cable Plugs	Ports	
HDMI			 <p> Warning Do not plug cables in upside down. Be sure to check the orientation of the plug before plugging it in.</p>
USB			
Optical			

- The TV does not support HDDs (Hard Disk Drives) connected to the USB port.

Network Troubleshooting

How to Improve Your Wireless Signal

Position your wireless router, modem router, or access point in a central location.

The best place for a Wi-Fi router is in the center of your home.

If that is not possible, move it as close to the center of your home as possible. Avoid putting it in a corner.

Single Story

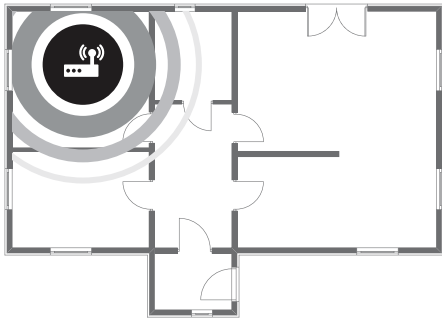

Bad Router Position

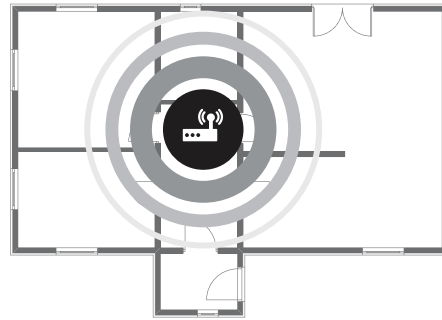

Good Router Position

Multi Story

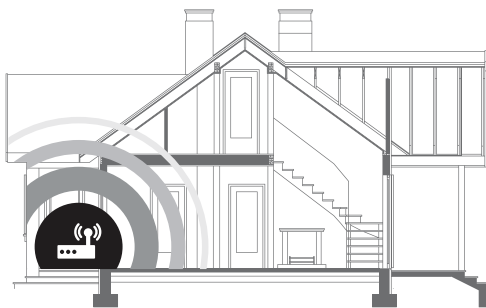

Bad Router Position

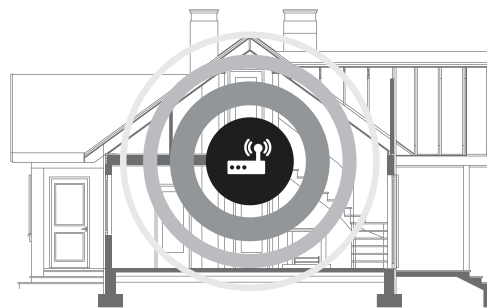

Good Router Position

Adding a wireless repeater

A wireless repeater is a device which extends your wireless network's range without requiring you to add any wiring. All you need to do is place the repeater halfway between your wireless router and your TV, and you will get an instant boost in your wireless signal strength.

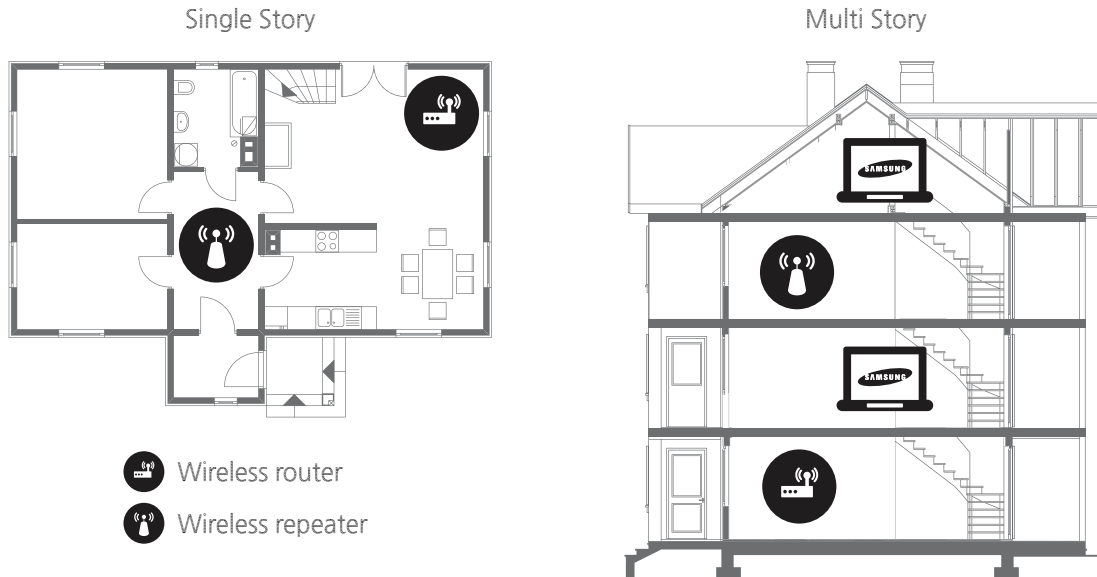

Do not locate the router on the floor and keep it away from walls and metal objects

Avoid placing the router near objects such as metal filing cabinets. Metal objects, walls, and floors will interfere with your router's wireless signal. The closer your router is to these obstructions, the more severe the interference, and the weaker the signal.

Reduce wireless interference

The most common wireless technology, 802.11g (wireless-G), operates at a frequency of 2.4GHz. Many cordless phones, microwave ovens, baby monitors, garage doors, and other wireless devices also use this frequency. Reduce interference by avoiding wireless devices that use the 2.4GHz frequency and use devices that communicate via the 5.0 GHz frequency instead.

Replace your router's antenna

If you must place your router in the corner, consider replacing your standard antenna with a Hi-Gain wireless antenna.

High gain antennas can be attached to most wireless routers. They boost the signal strength and aim the signal in one direction.

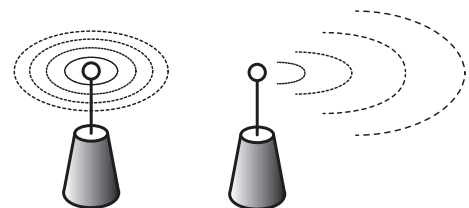

Intermittent Wi-Fi

- Check the distance between the Modem/Router and the TV. The distance should not exceed 50ft (15.2 m).
- Verify that there are no obstacles between your TV and the Modem/Router. (Appliances, cordless phones, stone walls/fireplaces, etc. decrease Wi-Fi strength.)
- Check the cable that connects the Modem to the Router (if you use a separate Modem and Router) to see if it is in good condition. If it is not, replace the cable.
- Connect the TV to your Modem/Router using a CAT 7 cable, and then try to set up a wired network connection. (**MENU > Network > Network Settings**).
- Check **Network Status** (**MENU > Network > Network Status**) to see if the IP address is invalid, for example, 169.x.x.x. If it is, call your ISP to get a valid IP address, and then ask them to check the connection between your Modem and Router and the connection between the Modem / Router and the Internet.
- If you see a valid Mac address, call your ISP and ask them to reset your network circuit to re-register the Mac addresses of your new Modem/Router and the TV.

Netflix problems

- Verify that your Modem/Router is no more than 50 ft (15.2 m) away from the TV.
- Change the DNS to 8.8.8.8. Select **MENU > Network > Network Status > DNS Server > Select Manually > DNS > enter 8.8.8.8 > OK**
- Verify that the ESN for Netflix is valid. (Go to **MENU > Support > Contact Samsung**)
Reset Netflix by selecting **MENU > Smart Hub > Smart Hub Reset**.

Smart Hub Error Messages

- Verify that the distance between the TV and the Modem/Router does not exceed 50 ft (15.2 m).
- Verify that the TV is connected to the network by checking the **Network Status** (**MENU > Network > Network Status**).
- Reset Smart Hub by selecting the **MENU > Smart Hub > Smart Hub Reset**.
- Update the TV's software (**MENU > Support > Software Update**).
- Wait 2 to 3 days for the issue to resolve itself.

Getting Remote Support

Samsung Remote Support service offers you one-on-one support with a Samsung Technician who can remotely:

- **Diagnose** your TV
- **Adjust the TV settings** for you
- **Perform a factory reset** on your TV
- Install recommended **firmware updates**

How Does Remote Support Work?

Having a Samsung Tech remotely service your TV is easy.



1. **Call the Samsung Contact Center** and ask for remote support.



2. **Open the menu** on your TV and go to the **Support** section.



3. Select **Remote Management**, and then read and agree to the service agreements. When the PIN screen appears, provide the PIN number to the agent.



4. The agent will then **access your TV**. That's it!

Caring for the TV

- If a sticker was attached to the TV screen, some debris can remain after you remove the sticker. Please clean the debris off before watching TV.
- The exterior and screen of the product can get scratched during cleaning. Be sure to wipe the exterior and screen carefully using a soft cloth to prevent scratches.

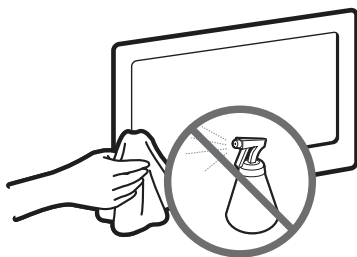

Do not spray water or any liquid directly onto the TV. Any liquid that goes into the product may cause a failure, fire, or electric shock.

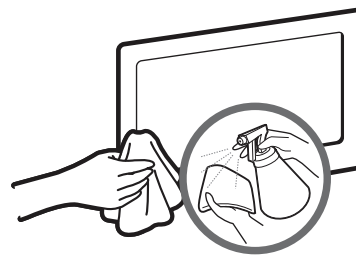

Turn off the TV, and then gently wipe away smudges and fingerprints on the screen with a micro-fiber cloth. Clean the body of the TV with a soft cloth dampened with a small amount of water. Do not use flammable liquids (benzene, thinners, etc.) or a cleaning agent. For stubborn smudges, spray a small amount of screen cleaner on the cloth.

06. Specifications, wall mounting, and other information

Specifications

Display Resolution	1366 x 768	
Environmental Considerations		
Operating Temperature	50°F to 104°F (10°C to 40°C)	
Operating Humidity	10% to 80%, non-condensing	
Storage Temperature	-4°F to 113°F (-20°C to 45°C)	
Storage Humidity	5% to 95%, non-condensing	
Stand Swivel (Left / Right)	0°	
Model Name	UN24H4500	UN28H4500
Screen Size (Diagonal)	24" Class (23.6" measured diagonally)	28" Class (27.5" measured diagonally)
Sound (Output)	3W x 2	5W x 2
Dimensions (W x H x D)		
Body	22.1 x 13.7 x 2.5 inches (561.8 x 349.1 x 65.1 (mm))	25.3 x 15.6 x 2.4 inches (643.4 x 396.5 x 62.9 (mm))
With stand	22.1 x 15.1 x 6.4 inches (561.8 x 384.2 x 163.8 (mm))	25.3 x 17.1 x 6.4 inches (643.4 x 435.0 x 163.4 (mm))
Weight		
Without Stand	8.5 lbs (3.9 kg)	8.1 lbs (3.7 kg)
With Stand	8.8 lbs (4.0 kg)	9.0 lbs (4.1 kg)

- Design and specifications are subject to change without prior notice.
- The actual appearance of the TV may differ from the images in this manual, depending on the model.
- This device is a Class B digital apparatus.
- For information about the power supply, and more information about power consumption, refer to the label attached to the product.
- Typical power consumption is measured according to Energy Star Program requirements for televisions.

Dispose unwanted electronics through an approved recycler.

To find the nearest recycling location, go to our website:

www.samsung.com/recyclingdirect or call, (877) 278 - 0799

Decreasing Power Consumption

When you shut the TV off, it enters Standby mode. In Standby mode, it continues to draw a small amount of power. To decrease power consumption, unplug the power cord when you don't intend to use the TV for a long time.

Dimensions

Port panel detail / Rear view

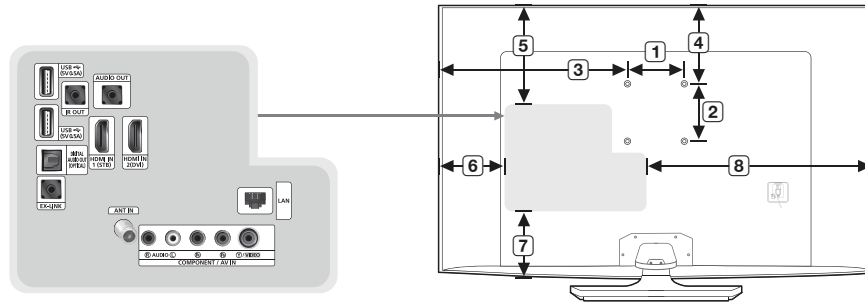

- The displayed image may differ depending on the model.

(Unit: inches)

Model name	1	2	3	4	5	6	7	8
UN24H4500	2.9	2.9	9.5	3.8	4.8	3.3	3.5	11.6
UN28H4500	3.9	3.9	10.6	5.5	5.7	3.0	4.4	15.4

All drawings are not necessarily to scale. Some dimensions are subject to change without prior notice. Refer to the dimensions before installing your TV. Not responsible for typographical or printed errors.

© 2014 Samsung Electronics America, Inc

Licenses



HDMI

The terms HDMI and HDMI High-Definition Multimedia Interface, and the HDMI Logo are trademarks or registered trademarks of HDMI Licensing LLC in the United States and other countries.

Still image warning

Avoid displaying still images (such as jpeg picture files), still image elements (such as TV channel logos, stock or news crawls at the screen bottom etc.), or programs in panorama or 4:3 image format on the screen. Constantly displaying still pictures can cause image burn-in on the LED screen, which will affect image quality. To reduce the risk of this effect occurring, please follow the recommendations below:

- Avoid displaying the same TV channel for long periods.
- Always try to display any image in full screen. Use the TV set's picture format menu for the best possible match.
- Reduce brightness and contrast to avoid the appearance of after-images.
- Use all TV features designed to reduce image retention and screen burn. Refer to the e-Manual for details.

Preventing burn-in.

Avoid keeping a still picture or a picture with static elements (black bars, black borders, logos, etc.) on your TV for more than two hours at a time. If that is unavoidable, change the picture or change to another channel for a minute or two every couple of hours. Reducing the brightness and contrast of the screen when it is displaying static elements will also help.

Mounting the TV on a Wall Using the Wall Mount Kit (Optional)



If you mount this product on a wall, it should be mounted only as recommended by the manufacturer. Unless it is correctly mounted, the product may slide or fall, causing serious injury to a child or adult, and serious damage to the product.

Installing the Wall Mount Kit

The wall mount kit (sold separately) lets you mount the TV on the wall.

For detailed information about installing the wall mount, see the instructions provided with the wall mount kit. We recommend you contact a technician for assistance when installing the wall mount bracket. We do not advise you to do it yourself. Samsung Electronics is not responsible for any damage to the product or injury to yourself or others if you select to install the wall mount on your own.

To order the wall mount kit, contact Samsung Customer Care at 1-800-SAMSUNG (1-800-726-7864).

< For 24 inch model >

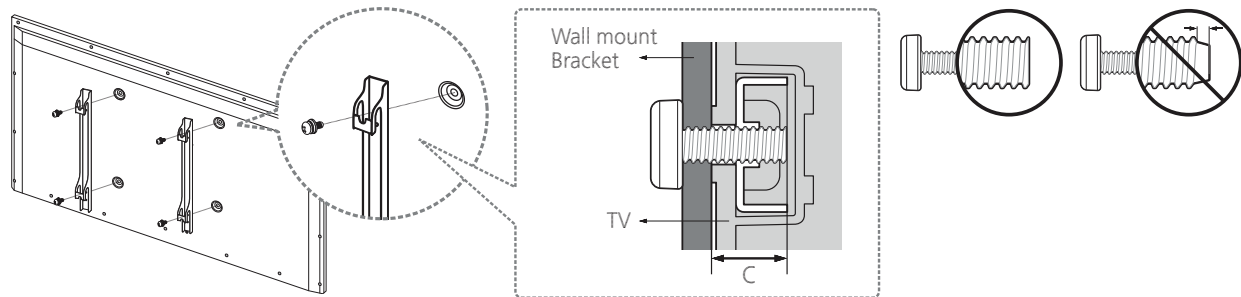

< For 28 inch model >

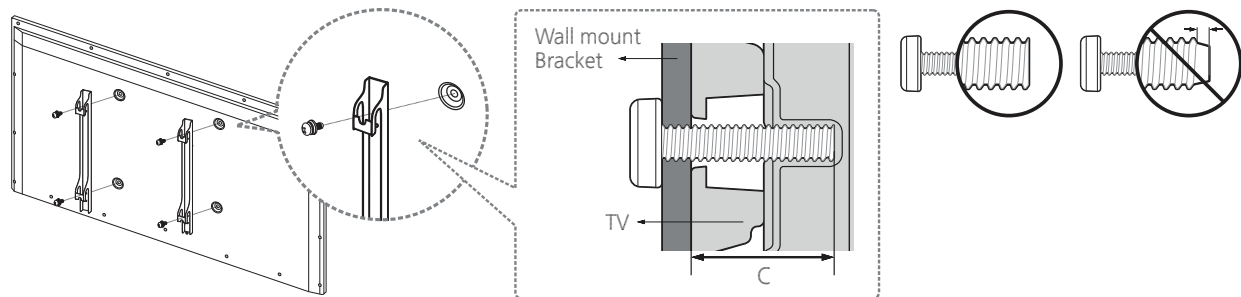

VESA Wall Mount Kit Notes and Specifications

Install your wall mount on a solid wall perpendicular to the floor. Before attaching the wall mount to surfaces other than plaster board, please contact your nearest dealer for additional information. If you install the TV on a ceiling or slanted wall, it may fall and result in severe personal injury.

When using a third-party wall mount, note that the assembling screw length(C) is shown below.

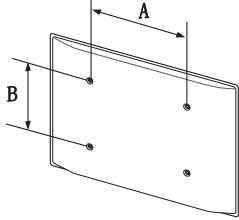
Product Family	TV size in inches	VESA screw hole specs (A * B) in millimeters	C (mm)	Standard Screw	Quantity	
LED-TV	24	75 x 75	6.3 ~ 9.3	M4	4	
	28	100 x 100	16.5 ~ 19.5			



Do not install your Wall Mount Kit while your TV is turned on. It may result in personal injury from electric shock.

- Standard dimensions for wall mount kits are shown in the table.
- Samsung wall mount kits contain a detailed installation manual, and all parts necessary for assembly are provided.
- Do not use screws that do not comply with VESA standard screw specifications.
- Do not use screws that are longer than the standard length or do not comply with VESA standard screw specifications. Screws that are too long may cause damage to the inside of the TV set.
- For wall mounts that do not comply with the VESA standard screw specifications, the length of the screws may differ depending on the wall mount specifications.
- Do not fasten the screws too firmly. This may damage the product or cause the product to fall, leading to personal injury. Samsung is not liable for these kinds of accidents.
- Samsung is not liable for product damage or personal injury when a non-VESA or non-specified wall mount is used or the consumer fails to follow the product installation instructions.
- Do not mount the TV at more than a 15 degree tilt.
- Always have two people mount the TV on to a wall.

Providing Proper Ventilation for Your TV

When you install your TV, maintain a distance of at least 4 inches between the TV and other objects (walls, cabinet sides, etc.) to ensure proper ventilation. Failing to maintain proper ventilation may result in a fire or a problem with the product caused by an increase in its internal temperature.

If you use parts provided by another manufacturer, it may cause difficulties with the product or result in injury caused by the product falling.

- Whether you install your TV using a stand or a wall-mount, we strongly recommend you use parts provided by Samsung Electronics only.

Installation with a stand.

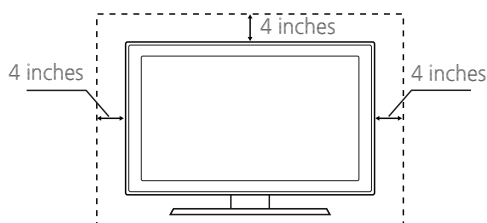

Installation with a wall-mount.

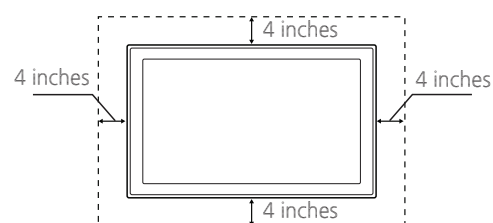

Securing the TV to the Wall



Caution: Pulling, pushing, or climbing on the TV may cause the TV to fall. In particular, ensure your children do not hang on or destabilize the TV. Doing so may cause the TV to tip over, causing serious injuries or death. Follow all safety precautions provided in the Safety Flyer included with your TV. For added stability and safety, you can purchase and install the anti-fall device as described below.

To Prevent the TV from Falling

These are general instructions. The clamps, screws, and string are not supplied by Samsung. They must be purchased separately. We suggest consulting an installation service or professional TV installer for specific hardware and anti-fall hardware installation.

1. Put the screws into the clamps and firmly fasten them onto the wall. Confirm that the screws have been firmly installed onto the wall.
 - You may need additional material such as an anchor depending on the type of wall.
2. Remove the screws from the back center of the TV, put the screws into the clamps, and then fasten the screws onto the TV again.
 - These screws may not be supplied with the TV. If they are not, purchase screws with the following specifications:
 - For a 24 - 28 inch model: M4

3. Connect the clamps fixed onto the TV and the clamps fixed onto the wall with a durable, heavy-duty string, and then tie the string tightly.

NOTE

- Install the TV near to the wall so that it does not fall backwards.
 - Connect the string so that the clamps fixed on the wall are at the same height to or lower than the clamps fixed on the TV.
 - Untie the string before moving the TV.
4. Verify all connections are properly secured. Periodically check the connections for any sign of fatigue or failure. If you have any doubt about the security of your connections, contact a professional installer.

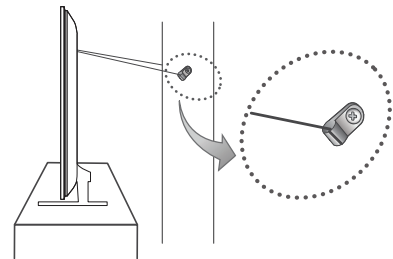
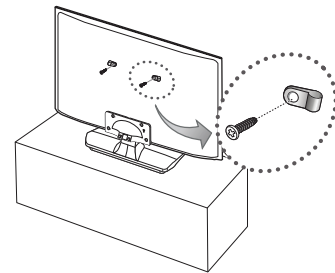

Warranty Information

Federal Communication Commission Interference Statement

This equipment has been tested and found to comply with the limits for a Class B digital device, pursuant to Part 15 of the FCC Rules. These limits are designed to provide reasonable protection against harmful interference in a residential installation. This equipment generates, uses and can radiate radio frequency energy and, if not installed and used in accordance with the instructions, may cause harmful interference to radio communications. However, there is no guarantee that interference will not occur in a particular installation. If this equipment does cause harmful interference to radio or television reception, which can be determined by turning the equipment off and on, the user is encouraged to try to correct the interference by one of the following measures:

- Reorient or relocate the receiving antenna.
- Increase the separation between the equipment and receiver.
- Connect the equipment into an outlet on a circuit different from that to which the receiver is connected.
- Consult the dealer or an experienced radio/TV technician for help.

FCC Caution: Any changes or modifications not expressly approved by the party responsible for compliance could void the user's authority to operate this equipment.

This device complies with Part 15 of the FCC Rules. Operation is subject to the following two conditions: (1) This device may not cause harmful interference, and (2) this device must accept any interference received, including interference that may cause undesired operation.

For product available in the USA/Canada market, only channel 1~11 can be operated. Selection of other channels is not possible.

This device and its antenna(s) must not be co-located or operation in conjunction with any other antenna or transmitter.

FCC Radiation Exposure Statement:

This equipment complies with FCC radiation exposure limits set forth for an uncontrolled environment. This equipment should be installed and operated with minimum distance 20cm between the radiator & your body.

IMPORTANT WARRANTY INFORMATION REGARDING TELEVISION FORMAT VIEWING

- See the warranty card for more information on warranty terms.

Wide screen format LED Displays (with 16:9 aspect ratios, the ratio of the screen width to height) are primarily designed to view wide screen format full-motion video. The images displayed on them should primarily be in the wide screen, 16:9 ratio format, or expanded to fill the screen, if your model offers this feature, with the images constantly in motion. Displaying stationary graphics and images on the screen, such as the dark sidebars on non-expanded standard format television video and programming, should be limited to no more than 5% of the total television viewing time per week.

Additionally, viewing other stationary images and text such as stock market crawls, video game displays, station logos, web sites or computer graphics and patterns, should be limited as described above for all televisions.

Displaying stationary images that exceed the above guidelines can cause uneven aging of LED Displays that leave subtle, but permanent burned-in ghost images in the LED picture. To avoid this, vary the programming and images, and primarily display full screen moving images, not stationary patterns or dark bars. On LED models that offer picture sizing features, use these controls to view different formats as a full screen picture.

Be careful about the television formats you select and the length of time you view them. Uneven LED aging as a result of format selection and use, as well as burned in images, are not covered by your Samsung limited warranty.

- SAMSUNG ELECTRONICS NORTH AMERICAN LIMITED WARRANTY STATEMENT

Subject to the requirements, conditions, exclusions and limitations of the original Limited Warranty supplied with Samsung Electronics (SAMSUNG) products, and the requirements, conditions, exclusions and limitations contained herein, SAMSUNG will additionally provide Warranty Repair Service in the United States on SAMSUNG products purchased in Canada, and in Canada on SAMSUNG products purchased in the United States, for the warranty period originally specified, and to the Original Purchaser only.

The above described warranty repairs must be performed by a SAMSUNG Authorized Service Center. Along with this Statement, the Original Limited Warranty Statement and a dated Bill of Sale as Proof of Purchase must be presented to the Service Center. Transportation to and from the Service Center is the responsibility of the purchaser. Conditions covered are limited only to manufacturing defects in material or workmanship, and only those encountered in normal use of the product.

Excluded, but not limited to, are any originally specified provisions for, in-home or on-site services, minimum or maximum repair times, exchanges or replacements, accessories, options, upgrades, or consumables.

For the location of a SAMSUNG Authorized Service Center, please call toll-free:

- In the United States: 1-800-SAMSUNG (1-800-726-7864)
- In Canada: 1-800-SAMSUNG

SAMSUNG BRAND PRODUCTS

LIMITED WARRANTY TO ORIGINAL PURCHASER

This SAMSUNG brand product, as supplied and distributed by SAMSUNG and delivered new, in the original carton to the original consumer purchaser, is warranted by SAMSUNG against manufacturing defects in materials and workmanship for period of: (90 Days Parts and Labor for Commercial Use)

Categories	Parts	Labor	Size	Service
LCD/LED TV	1 Year	1 Year	39" and Larger	Carry-In or In Home
			37" and Smaller	Carry-In
Plasma Display	1 Year	1 Year	All	Carry-In or In Home
3D Glasses	1 Year	1 Year	-	Carry-In or Pick up

** 180 Days after Purchasing and 600 Hours of Use Lamp on Projector

This limited warranty begins on the original date of purchase, and is valid only on products purchased and used in the United States. To receive warranty service, the purchaser must contact SAMSUNG for problem determination and service procedures.

Warranty service can only be performed by a SAMSUNG authorized service center. The original dated bill of sale must be presented upon request as proof of purchase to SAMSUNG or SAMSUNG's authorized service center.

SAMSUNG will repair or replace this product, at our option and at no charge as stipulated herein, with new or reconditioned parts or products if found to be defective during the limited warranty period specified above. All replaced parts and products become the property of SAMSUNG and must be returned to SAMSUNG. Replacement parts and products assume the remaining original warranty, or ninety (90) days, whichever is longer.

Certain products are eligible for In-home service at Samsung's discretion. To receive in-home service, the product must be unobstructed and accessible to service personnel. If during in-home service, repair cannot not be completed, it may be necessary to remove, repair and return the product. If in-home service is unavailable, SAMSUNG may elect, at our option, to provide for transportation of our choice to and from a SAMSUNG authorized service center. Otherwise, and for 37" and smaller LCD/LED TV, transportation to and from the SAMSUNG authorized service center is the responsibility of the purchaser.

This limited warranty covers manufacturing defects in materials and workmanship encountered in normal, and except to the extent otherwise expressly provided for in this statement, noncommercial use of this product, and shall not apply to the following, including, but not limited to: damage which occurs in shipment; delivery and installation; applications and uses for which this product was not intended; altered product or serial numbers; cosmetic damage or exterior finishes; accidents, abuse, neglect, fire, water, lightning or other acts of nature; use of products, equipment, systems, utilities, services, parts, supplies, accessories, applications, installations, repairs, external wiring or connectors not supplied or authorized by SAMSUNG which damage this product or result in service problems; incorrect electrical line voltage, fluctuations and surges; customer adjustments and failure to follow operating instructions, cleaning, maintenance and environmental instructions that are covered and prescribed in the instruction book; reception problems and distortion related to noise, echo, interference or other signal transmission and delivery problems; brightness related to normal aging, or burned-in images. SAMSUNG does not warrant uninterrupted or error-free operation of the product.

THERE ARE NO EXPRESS WARRANTIES OTHER THAN THOSE LISTED AND DESCRIBED ABOVE, AND NO WARRANTIES WHETHER EXPRESS OR IMPLIED, INCLUDING, BUT NOT LIMITED TO, ANY IMPLIED WARRANTIES OF MERCHANTABILITY OR FITNESS FOR A PARTICULAR PURPOSE, SHALL APPLY AFTER THE EXPRESS WARRANTY PERIODS STATED ABOVE, AND NO OTHER EXPRESS WARRANTY OR GUARANTY GIVEN BY ANY PERSON, FIRM OR CORPORATION WITH RESPECT TO THIS PRODUCT SHALL BE BINDING ON SAMSUNG. SAMSUNG

SHALL NOT BE LIABLE FOR LOSS OF REVENUE OR PROFITS, FAILURE TO REALIZE SAVINGS OR OTHER BENEFITS, OR ANY OTHER SPECIAL, INCIDENTAL OR CONSEQUENTIAL DAMAGES CAUSED BY THE USE, MISUSE OR INABILITY TO USE THIS PRODUCT, REGARDLESS OF THE LEGAL THEORY ON WHICH THE CLAIM IS BASED, AND EVEN IF SAMSUNG HAS BEEN ADVISED OF THE POSSIBILITY OF SUCH DAMAGES. NOR SHALL RECOVERY OF ANY KIND AGAINST SAMSUNG BE GREATER IN AMOUNT THAN THE PURCHASE PRICE OF THE PRODUCT SOLD BY SAMSUNG AND CAUSING THE ALLEGED DAMAGE. WITHOUT LIMITING THE FOREGOING, PURCHASER ASSUMES ALL RISK AND LIABILITY FOR LOSS, DAMAGE OR INJURY TO PURCHASER AND PURCHASER'S PROPERTY AND TO OTHERS AND THEIR PROPERTY ARISING OUT OF THE USE, MISUSE OR INABILITY TO USE THIS PRODUCT SOLD BY SAMSUNG NOT CAUSED DIRECTLY BY THE NEGLIGENCE OF SAMSUNG. THIS LIMITED WARRANTY SHALL NOT EXTEND TO ANYONE OTHER THAN THE ORIGINAL PURCHASER OF THIS PRODUCT, IS NONTRANSFERABLE AND STATES YOUR EXCLUSIVE REMEDY.

Some states do not allow limitations on how long an implied warranty lasts, or the exclusion or limitation of incidental or consequential damages, so the above limitations or exclusions may not apply to you. This warranty gives you specific legal rights, and you may also have other rights which vary from state to state.

To obtain warranty service, please contact SAMSUNG at:

Samsung Electronics America, Inc.

85 Challenger Road

Ridgefield Park, NJ 07660-2112

1-800-SAMSUNG 726-7864 - www.samsung.com

1-800-749-0260: Projectors only

The benefits of this Limited Warranty extend only to the original purchaser of Samsung products from an authorized Samsung reseller. THIS LIMITED WARRANTY SHALL NOT APPLY TO ANY SAMSUNG PRODUCTS PURCHASED FROM UNAUTHORIZED RESELLERS OR RETAILERS, EXCEPT IN STATES WHERE SUCH RESTRICTION MAY BE PROHIBITED. For a list of Samsung authorized retailers, please go to: http://www.samsung.com/us/peaceofmind/authorized_resellers.html.



Contact SAMSUNG WORLD WIDE

If you have any questions or comments relating to Samsung products, please contact the SAMSUNG customer care center.

Country	Customer Care Center ☎	Web Site	Address
CANADA	1-800-SAMSUNG (726-7864)	www.samsung.com/ca/ support (English) www.samsung.com/ca_fr/ support (French)	Samsung Electronics Canada Inc. 2050 Derry Road West, Mississauga, Ontario L5N 0B9 Canada
U.S.A	1-800-SAMSUNG (726-7864)	www.samsung.com/us/ support	Samsung Electronics America, Inc. 85 Challenger Road Ridgefield Park, NJ 07660



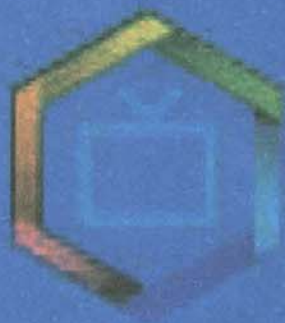

Samsung Smart TV

Setup Guide



BN68-06556A-03

1

Unpack

Taking the TV Out of the Box



- **Warning:**
Do not touch the TV's screen when you take it out of the box. Hold it by its edges only. If you touch the screen, you can cause the TV panel to crack.
- **Recommendation 1:**
Two people should remove the TV from the box as shown above. When removing the TV, hold it by its edges only. Do not touch the screen.
- **Recommendation 2:**
If only one person is available to remove the TV from the box, remove it as shown in the illustration above. Hold the TV by its edges. Do not touch the screen.

Included in the Box

Remote Control

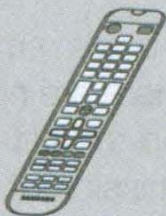

Remote Control



Batteries (2 AAA)

Also included

- User manual
- Regulatory guide

Stand Parts and Cables



Base



Stand Mount
(28 inch model only)



Screws
(24 inch model: 3
28 inch model: 7)



Cable Holder



Power Cord



IR Extender Cable

2

Assemble

Stand and styrofoam shape may vary differ depending on the model.

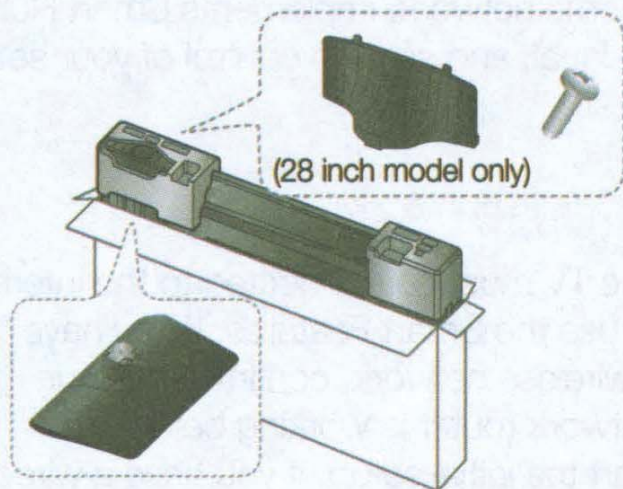

1 Locate the Base, Stand Mount, and Screws in the box and set them aside.

 Remove the top portion of the box to locate the stand parts.

< For 24inch model >

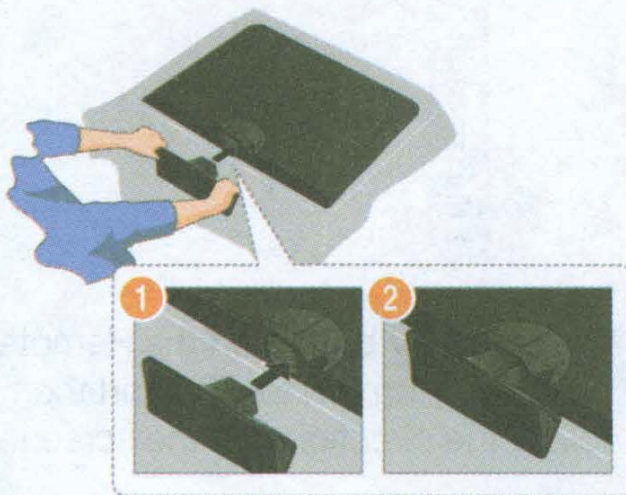

3 As shown in the diagram, insert the stand to hole at the bottom of the TV.

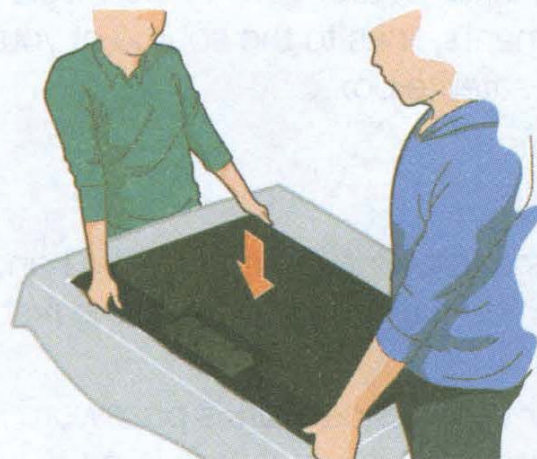

2 Place the TV on a soft surface, screen side down. Use the packing material to protect the screen.



4 As shown in the diagram, insert 3 screws at the bottom of the stand use a screwdriver.

 x3 (M4 X L12)

< For 28inch model >

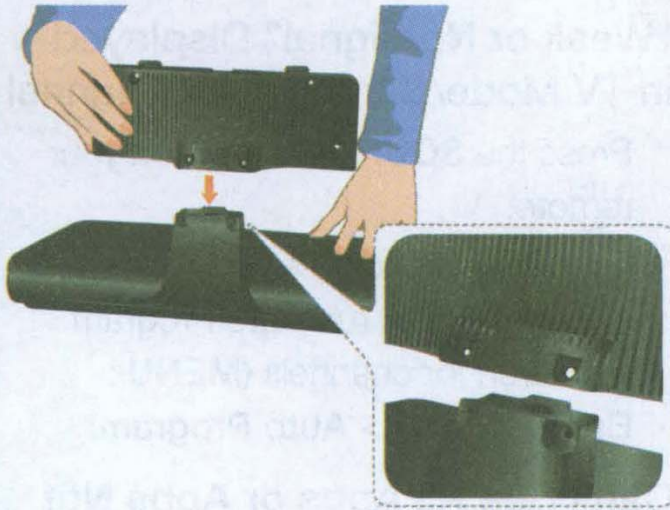

- 3** Fit the Base and Stand Mount together, making sure the notch on the Stand Mount aligns with the Base.

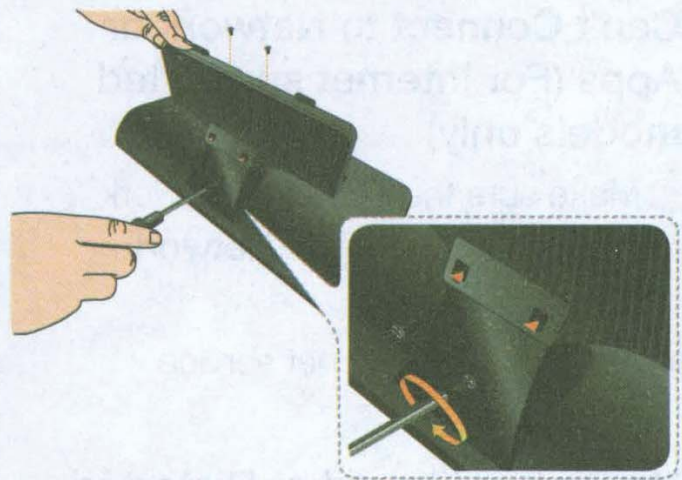

- 4** Insert 4 screws and secure the Base to the Stand Mount.
x4 (M4 X L12)

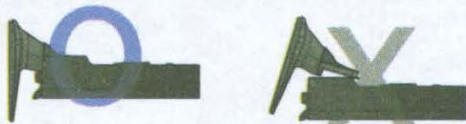
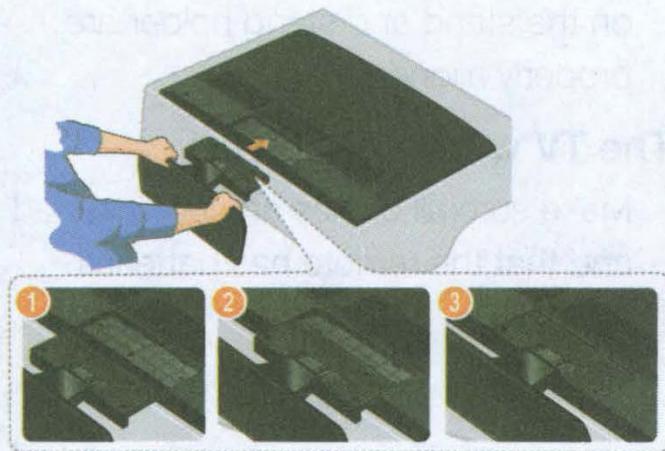

- 5** Holding the stand parallel to the screen, slide the Stand Mount into the notches on the back of the TV.

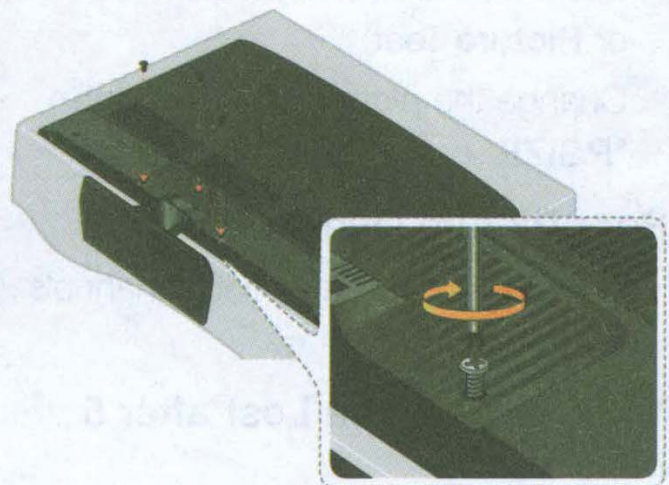

- 6** Insert 3 screws, and then use a screwdriver to secure the stand to the TV.
x3 (M4 X L12)

3

Connect

* Recommended Connections

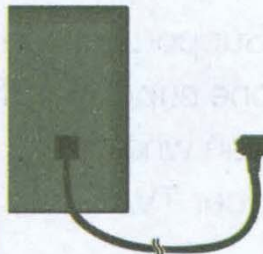

After you have connected all your external devices, plug the TV's power cord into the back of the TV. **DO NOT** plug it into a wall outlet until you have reached Section 6, Initial Setup.

Connection panel on the back of the TV

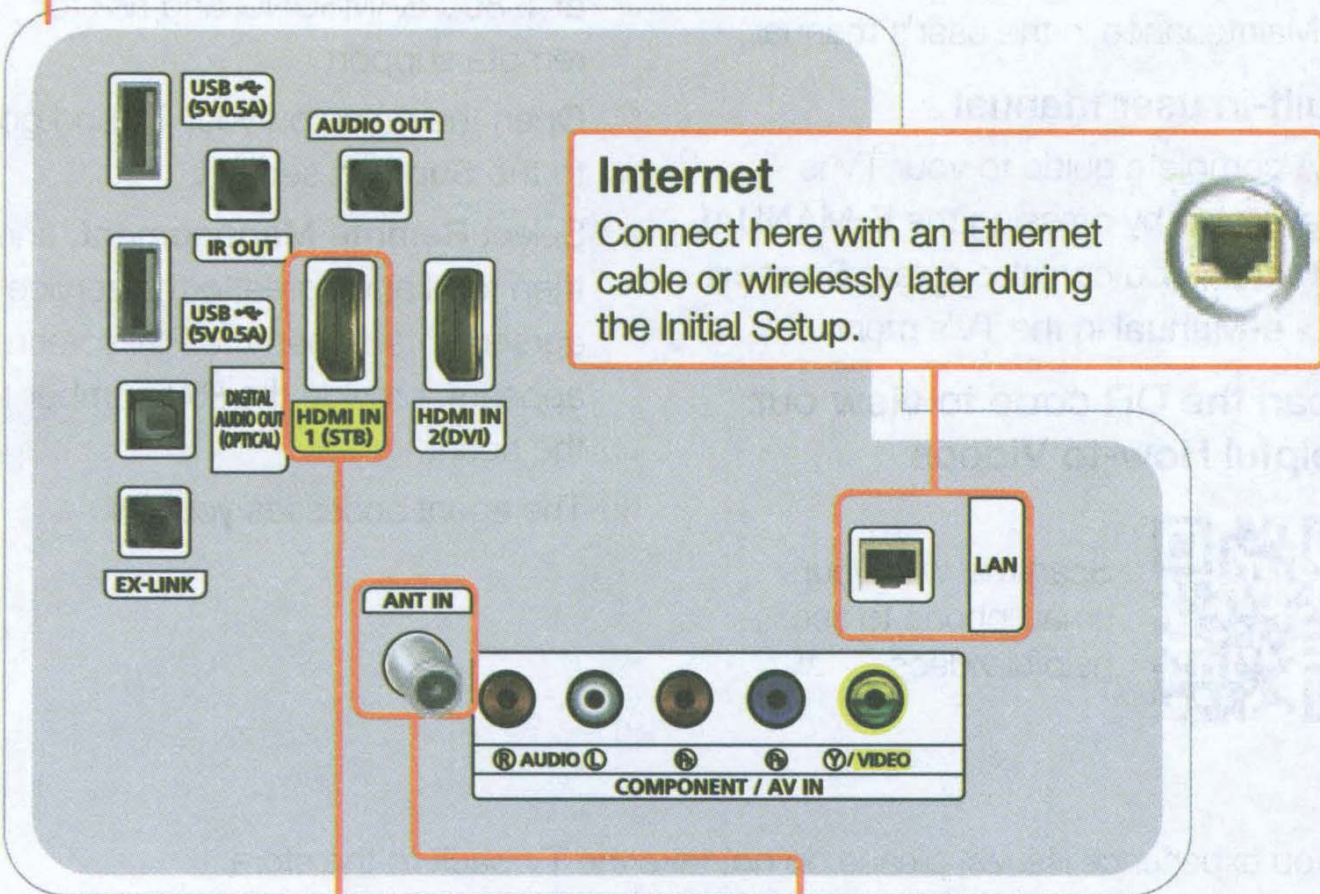

Internet
Connect here with an Ethernet cable or wirelessly later during the Initial Setup.



Cable/Satellite/DVR
Connect your set-top box or digital video recorder with an HDMI cable.



TV signal
Connect your coaxial cable to the Antenna In port.



4

Gear

* Recommended Connections

Game console

Connect your game console or PC/DVI using an HDMI cable.

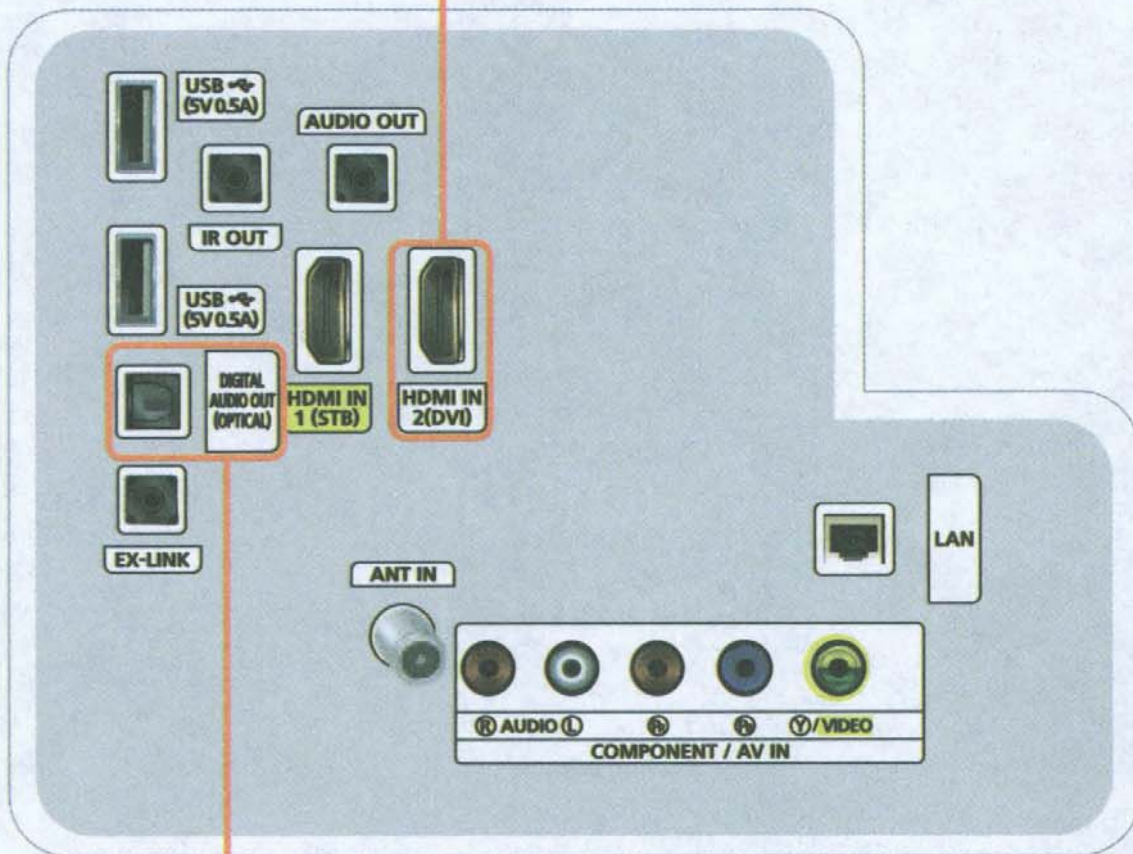

Audio

Connect a receiver/home theater using an optical audio cable.



5 STB Control

You can control your set-top-box or satellite box with the Remote Control. To establish control, you must first set up the IR extender cable. If you don't have an STB, skip this section.

- 1 Connect the IR extender cable to the TV's IR output connector.

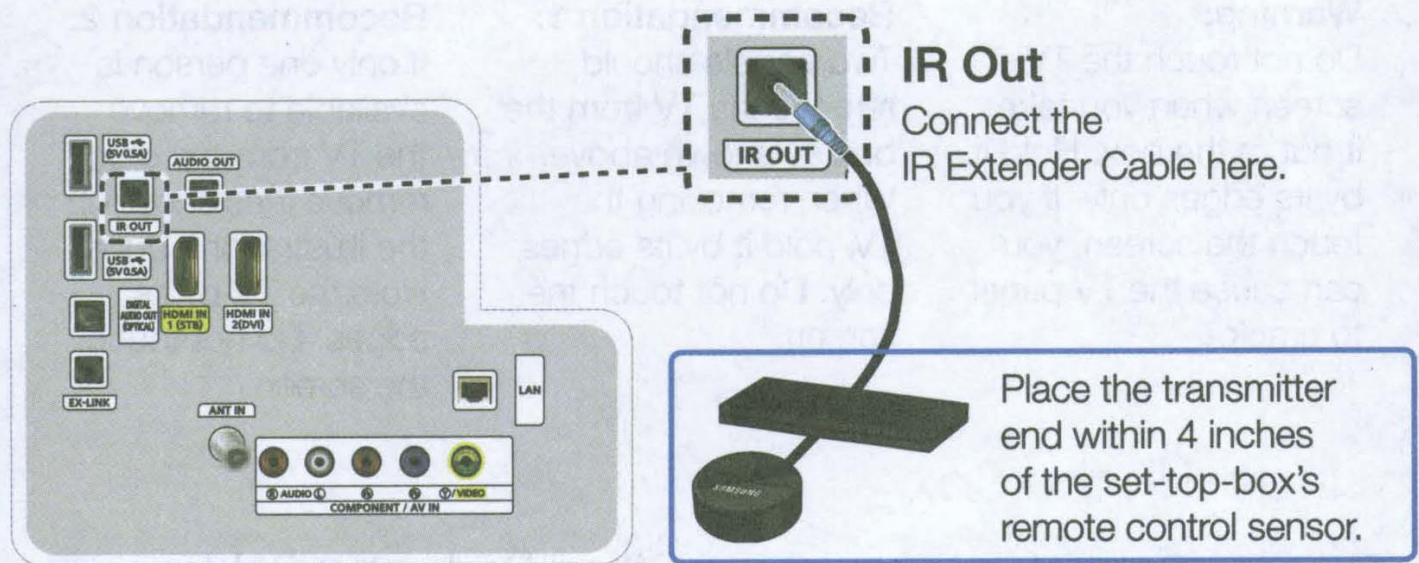

- 2 Position the transmitter end within 4 inches (10 cm) of the set-top-box's remote control sensor, pointing in the direction of the sensor. Make sure there are no obstacles between the transmitter end of the IR extender cable and the set-top-box or satellite box. Any obstacles will interfere with the transmission of the remote control signals.
- 3 Finalize control of your set-top or satellite box when you run Initial Setup.

6

Initial Setup

When you turn on your TV for the first time, it immediately starts the Initial Setup. During Initial Setup, your TV connects to your home network, implements Smart Hub agreements, links to the source of your live TV signal, and sets up control of your set-top or satellite box.

Information You Need

Have the following information on hand before you turn on your TV for the first time:

- Your wireless network's password. (Make sure your network is on.)
- Your Postal or Zip code.
- The name and location of your cable or satellite provider (if you use one).

Internet Access

The TV must be connected to the Internet to use the Smart Features. If you have a wireless network, confirm that your network router is working before you start the initial setup. If you have a wired network, connect the TV to the network with an Ethernet cable before you begin (CAT 7 cable preferred).

Running Initial Setup

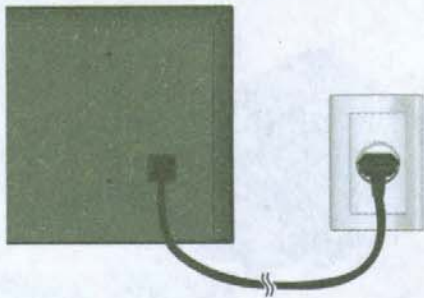

- 1 Plug your TV into a wall outlet.
- 2 Aim the Remote Control at the TV.

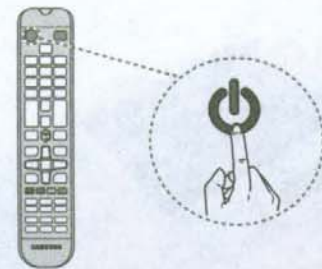

- 3 Press the **TV** button on the Remote Control to turn on the TV, and then follow the directions on the screen.

To learn more about operating your TV and its Smart Features, see your TV's user's manual or launch the TV's built in e-Manual. Congratulations on the purchase of your new Smart TV!

Common issues

Can't Connect to Network or Apps (For Internet supported models only)

Make sure the TV has a network connection (**MENU > Network > Network Status**)

- Contact your Internet service provider.

No Picture/Sound or Distorted Picture/Sound from an External Device

Make sure your connection to the device is correct.

Perform a TV Self Diagnosis to identify the problem (**MENU > Support > Self Diagnosis > Sound or Picture Test**)

Change the picture size. (Use the "P.SIZE" button on your remote.)

Poor Picture Quality

- Select High Definition (HD) channels or programs.

Your Settings are Lost after 5 Minutes

Change to Home Mode (**MENU > Support > Use Mode > Home Use**)

"Weak or No Signal" Displayed in TV Mode/Cannot Find Channel

Press the **SOURCE** button on your remote.

If the TV is not connected to a cable or satellite box, run Auto Program to search for channels (**MENU > Broadcasting > Auto Program**)

Can't See All Apps or Apps Not Working

Reset Smart Hub (**MENU > Smart Hub > Smart Hub Reset**)

The stand is wobbly or crooked

Make sure the indicator arrows on the stand and stand holder are properly aligned.

The TV won't turn on

Make sure all cables are fully inserted and that the remote has batteries installed.

More help

REQUIRE ASSISTANCE WITH YOUR PRODUCT?

Purchase any Samsung TV and you'll enjoy the convenience of Samsung Service. If you require any assistance with your TV, first try any of Samsung's helpful support options listed here.

Troubleshooting

- For more quick solutions to common issues, see Troubleshooting and Maintenance in the user's manual.

Built-in user manual

A complete guide to your TV is available by pressing the **E-MANUAL** button. You can also select **Support** > **e-Manual** in the TV's menu.

Scan the QR code to view our helpful How-to Videos

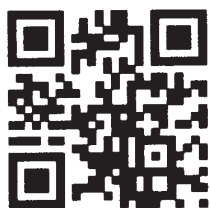

Scan this with your smart phone to see helpful videos.

If you experience issues, please do not take the TV back to the store.

In the United States of America, call us at 1-800-SAMSUNG (1-800-726-7864) or visit us at www.samsung.com or www.samsung.com/spsn for support and warranty service.

Tech Support and Chat

www.samsung.com/support

Remote Support

- Samsung Remote Support service offers you one-on-one support with a Samsung Technician who can remotely diagnose your TV.

For Remote Support:

- Call the Samsung Contact Center at 1-800-SAMSUNG and ask for remote support.
- Open the menu on your TV and go to the **Support** section.
- Select **Remote Management**, and then read and agree to the service agreements. When the PIN screen appears, provide the PIN number to the agent.
- The agent accesses your TV.

IMPORTANT SAFETY PRECAUTIONS

If a television is not positioned in a sufficiently stable location, it can be potentially hazardous due to falling. Many injuries, particularly to children, can be avoided by taking simple precautions such as:

- Placing the television on a platform, stand, cabinet, table or other surface which is:
 - recommended by Samsung or sold with the product;
 - secure and stable;
 - sufficiently wider in the base than the base measurement of the television;
 - strong and large enough to support the size and weight of the television.
- Positioning the television close to the wall to avoid the possibility of the television falling when pushed.
- Ensuring your television is installed by an authorized Samsung installer.
- Following the instructions for wall mounting in the installation manual and using the mounting equipment supplied by Samsung.
- Placing the television toward the back of the furniture or surface on which it is placed.
- Ensuring that the television does not hang over the edge of the furniture or surface on which it is placed.
- Not hanging anything from or on the television.
- Anchoring both the television and the furniture on which it is placed to a suitable support especially in the case of tall furniture, such as cupboards or bookcases which exceed one metre in height. This can be done by using sturdy brackets, safety straps or mounts that are made specifically for flat screen televisions.
- Not placing any material between the television and the furniture on which it is placed.
- If the furniture on which the television is placed has drawers, cabinets or shelves under the television, taking steps to prevent children from climbing, such as installing safety latches so the doors cannot be opened.
- Keeping pets away from the television.
- Educating children about the dangers of climbing on furniture to reach the television or its control.

Failure to take these safety precautions may cause the television to fall from the stand or mounting equipment, causing damage or serious injury.

Regulatory Compliance Statements

Your Samsung product compliance class is marked in the user manual

- Federal Communications Commission (FCC) - USA
- Industry Canada Equipment Standard for Digital Equipment (ICES-003) - Canada
- Voluntary Control Council for Interference (VCCI) - Japan
- Bureau of Standards Metrology and Inspection (BSMI) - Taiwan
- Korea Communications Commission(KCC) - Republic of Korea
- Italian Post Ministry (Homologation) - Italy

FCC Class A Notice

This device complies with part 15 of the FCC Rules. Operation is subject to the following two conditions:

1. This device may not cause harmful interference, and
2. This device must accept any interference received, including interference that may cause undesired operation.

☞ This equipment has been tested and found to comply with the limits for a Class A digital device, pursuant to Part 15 of the FCC Rules. These limits are designed to provide reasonable protection against harmful interference when the equipment is operated in a commercial environment. This equipment generates, uses, and can radiate radio frequency energy and, if not installed and used in accordance with the instruction manual, may cause harmful interference to radio communications. Operation of this equipment in a residential area is likely to cause harmful interference in which case the user will be required to correct the interference at his own expense.

FCC Class B Notice

This device complies with part 15 of the FCC Rules. Operation is subject to the following two conditions:

1. This device may not cause harmful interference, and
 2. This device must accept any interference received, including interference that may cause undesired operation.
- ☑ This equipment has been tested and found to comply with the limits for a Class B digital device, pursuant to Part 15 of the FCC Rules. These limits are designed to provide reasonable protection against harmful interference in a residential installation. This equipment generates, uses and can radiate radio frequency energy and, if not installed and used in accordance with the instructions, may cause harmful interference to radio communications. However, there is no guarantee that interference will not occur in a particular installation. If this equipment does cause harmful interference to radio or television reception, which can be determined by turning the equipment off and on, the user is encouraged to try to correct the interference by one or more of the following measures:
- Reorient or relocate the receiving antenna.
 - Increase the separation between the equipment and receiver.
 - Connect the equipment into an outlet on a circuit different from that to which the receiver is connected.
 - Consult the dealer or an experienced radio/TV technician for help.

User Information

Changes or modifications not expressly approved by the party responsible for compliance could void the user's authority to operate the equipment. If necessary, consult with your dealer or an experienced radio/television technician for additional suggestions. You may find the booklet called How to Identify and Resolve Radio/TV Interference Problems helpful. This booklet was prepared by the Federal Communications Commission. It is available from the U.S. Government Printing Office, Washington, DC 20402, Stock Number 004-000-00345-4.

The party responsible for product compliance:

SAMSUNG ELECTRONICS CO., LTD.
America QA Lab of Samsung
3351 Michelson Drive
Suite #290, Irvine, CA92612 USA

Warning

User must use shielded signal interface cables to maintain FCC compliance for the product. Provided with this monitor is a detachable power supply cord with IEC320 style terminations. It may be suitable for connection to any UL Listed personal computer with similar configuration. Before making the connection, make sure the voltage rating of the computer convenience outlet is the same as the monitor and that the ampere rating of the computer convenience outlet is equal or exceeds the monitor voltage rating. For 120 Volt applications, use only UL Listed detachable power cord with NEMA configuration 5-15P type(parallel blades) plug cap. For 240 Volt applications use only UL Listed detachable power supply cord with NEMA configuration 6-15P type (tandem blades) plug cap. This television receiver provides display of television closed captioning in accordance with Section 15.119 of the FCC rules. (TV broadcast receivers with picture screens 13 inches or larger in diameter models only)

ICES-003 Class A Notice - Avis NMB-003, Classe A

This Class A digital apparatus complies with Canadian ICES-003.
Cet appareil numérique de la classe A est conforme à la norme NMB-003 du Canada.

ICES-003 Class B Notice - Avis NMB-003, Classe B

This Class B digital apparatus complies with Canadian ICES-003.
Cet appareil numérique de la classe B est conforme à la norme NMB-003 du Canada.

VCCI Class A Notice

この装置は、クラスA 情報技術装置です。
この装置を家庭環境で使用すると電波妨害を引き起こすことがあります。
この場合には使用者が適切な対策を講ずるよう要求されることがあります。

VCCI Class B Notice

この装置は、クラスB 情報技術装置です。
この装置は、家庭環境で使用することを目的としていますが、この装置がラジオやテレビジョン受信機に近接して使用されると、受信障害を引き起こすことがあります。
取扱説明書に従って正しい取り扱いをして下さい。

CCC Class A notice - China

此为A级产品，在生活环境中，该产品可能会造成无线电干扰。
在这种情况下，可能需要用户对其干扰采取切实可行的措施。

BSMI Class A Notice

The following statement is applicable to products shipped to Taiwan and marked as Class A on the product compliance label.

警告使用者：

此為甲類資訊技術設備，於居住環境中使用時，可能會造成射頻擾動，在此種情況下，使用者會被要求採取某些適當的對策。



European Notice(Europe Only)

Products with the CE marking comply with the EMC Directive(2004/108/EC) and the Low Voltage Directive(2006/95/EC) issued by the Commission of the European Community.

Compliance with these directives implies conformity to the following European Norms:

- EN55022: Radio Frequency Interference
- EN55024: Electromagnetic Immunity of Information Technology Equipment
- EN61000-3-2: Power Line Harmonics
- EN61000-3-3: Voltage Fluctuations
- EN55013: Radio disturbance characteristics of broadcast receivers and associated equipments
- EN55020: Electromagnetic immunity of broadcast receivers and associated equipments

European Class A Warning

(If the user manual declares the product as Class A, following statement applies.)

This is a class A product. In a domestic environment this product may cause radio interference in which case the user may be required to take adequate measures.

A급 기기 (업무용 방송통신기자재)

이 기기는 업무용(A급) 전자파적합기기로서 판매자 또는 사용자는 이 점을 주의하시기 바라며, 가정외의 지역에서 사용하는 것을 목적으로 합니다.

B급 기기 (가정용 방송통신기자재)

이 기기는 가정용(B급) 전자파적합기기로서 주로 가정에서 사용하는 것을 목적으로 하며, 모든 지역에서 사용할 수 있습니다.

Italian Homologation Notice

Questo apparecchio e fabbricato in conformita al D.M.28.08.95 n.548

ed in particolare a quanto specificato nell Art.2, comma 1.

Questo apparecchio e fabbricato nella U.E. in conformita al D.M.28.08.95 n.548

Art.2, comma 1 ed al D.M.26.03.92 Art.1

- For products produced in countries except European Community
Questo apparecchio e fabbricato in conformita al D.M.28.08.95 n.548
ed in particolare a quanto specificato nell Art.2, comma 1.
- For products produced in European Community
Questo apparecchio e fabbricato nella U.E. in conformita al D.M.28.08.95 n.548
Art.2, comma 1 ed al D.M.26.03.92 Art.1

碱性及非碱性锌-二氧化锰电池中 汞、镉、铅含量的限制要求

标准：GB/T- 8897. 2. -2013

注意：使用前请确认电池正负极。请勿将电池拆卸、焚烧或充电。不同种类电池不可混用。长期不用时，请取出电池。

含量汞：“低汞”或“无汞”

锌-氧化银、锌-空气、锌-二氧化锰 扣式电池中汞含量的限制要求

标准：GB/T- 8897. 2. -2013

注意：使用前请确认电池正负极。请勿将电池拆卸、焚烧或充电。不同种类电池不可混用。

长期不用时，请取出电池。将电池远离儿童，如误吞食，请即刻就医。

含量汞：“无汞”或“无含量≤20 mg/g”

[BRAZIL] Pilhas e baterias, após seu uso, não devem ser jogadas em lixo comum. Para evitar riscos à saúde humana e ao meio ambiente, realize o descarte ambientalmente adequado, em um Serviço Autorizado Samsung.

Important Safety Instructions (UL Only)

1. Read these instructions.
2. Keep these instructions.
3. Heed all warnings.
4. Follow all instructions.
5. Do not use this apparatus near water.
6. Clean only with dry cloth.
7. Do not block any ventilation openings, install in accordance with the manufacturer's instructions.
8. Do not install near any heat sources such as radiators, heat registers, stoves, or other apparatus (including amplifiers) that produce heat.
9. Do not defeat the safety purpose of the polarized or grounding-type plug. A polarized plug has two blades with one wider than the other. A grounding type plug has two blades and a third grounding prong. The wide blade or the third prong are provided for your safety. If the provided plug does not fit into your outlet, consult an electrician for replacement of the obsolete outlet.
10. Protect the power cord from being walked on or pinched particularly at plugs, convenience receptacles, and the point where they exit from the apparatus.
11. Only use attachments/accessories specified by the manufacturer.
12. Use only with cart, stand, tripod, bracket, or table specified by the manufacturer, or sold with the apparatus. When a cart is used, use caution when moving the cart/apparatus combination to avoid injury from tip-over.
13. Unplug this apparatus during lightning storms or when unused for long periods of time.
14. Refer all servicing to qualified service personnel. Servicing is required when the apparatus has been damaged in any way, such as power-supply cord or plug is damaged, liquid has been spilled or objects have fallen into the apparatus, the apparatus has been exposed to rain or moisture, does not operate normally, or has been dropped.



▲ WARNING: To prevent damage which may result in fire or electric shock hazard, do not expose this appliance to rain or moisture.

• Ventilation

Do not place the apparatus in a rack or bookcase. Ensure that there is adequate ventilation and that you've followed that manufacturer's instructions for mounting and installation.

MPR II Compliance (MPR II applied model only)

This monitor complies with SWEDAC(MPR II) recommendations for reduced electric and magnetic fields.

ENERGY STAR qualified model only (Applicable to tuner-included models only)

- Your Samsung TV is ENERGY STAR qualified in its "factory default(Home Use)" setting. Change to certain features, settings and functionality in this TV can change the power consumption, possibly beyond the limits required for ENERGY STAR qualification.
- Environmental Protection Agency and Department of Energy. ENERGY STAR is a joint program of the Government agencies, designed to promote energy efficient products and practices.

Refer to www.energystar.gov for more information of the ENERGY STAR Program.



ENERGY STAR qualified model only (The other models)

- As an ENERGY STAR Partner, Samsung has determined that this product or product models meets the ENERGY STAR guideline for energy efficiency.



Mercury Statement (LCD Monitor, LCD TV, DLP Projection TV, Projector for USA only)

Contains Mercury, Dispose According to Local, State or Federal Laws

Wiring the Mains Power Supply Plug(UK Only)

IMPORTANT NOTICE

The mains lead on this equipment is supplied with a moulded plug incorporating a fuse. The value of the fuse is indicated on the pin face of the plug and, if it requires replacing, a fuse approved to BSI1362 of the same rating must be used.

Never use the plug with the fuse cover omitted if the cover is detachable. If a replacement fuse cover is required, it must be of the same colour as the pin face of the plug. Replacement covers are available from your dealer.

If the fitted plug is not suitable for the power points in your house or the cable is not long enough to reach a power point, you should obtain a suitable safety approved extension lead or consult your dealer for assistance. However, if there is no alternative but to cut off the plug, remove the fuse and then safely dispose of the plug.

Do NOT connect the plug to a mains socket as there is a risk of shock hazard from the bared flexible cord.

IMPORTANT

The wires in the mains lead are coloured in accordance with the following code:

BLUE - NEUTRAL BROWN - LIVE

As these colours may not correspond to the coloured markings identifying the terminals in your plug, proceed as follows :

The wire coloured BLUE must be connected to the terminal marked with the letter N or coloured BLUE or BLACK. The wire coloured BROWN must be connected to the terminal marked with the letter L or coloured BROWN or RED.

WARNING:

DO NOT CONNECT EITHER WIRE TO THE EARTH TERMINAL, WHICH IS MARKED WITH THE LETTER E OR BY THE EARTH SYMBOL , OR COLOURED GREEN OR GREEN AND YELLOW.

EU Eco-Label (EU Eco-Label applied model only)

Products which have model codes that end in XU are intended for the UK market. Samsung has not applied for Ecolabels for products with this specific model code.



Better for the environment...

- *High Energy Efficiency*
- *Reduced CO₂ emissions*
- *Designed to facilitate repair and recycling*

...better for you.

EU Ecolabel : HU/022/03

SAMSUNG Electronics makes an effort to develop environment-friendly product that minimizing an impact to environment through whole process from getting raw materials, production, transportation, usage and end-of-life disposal by adding 'environment' on function, price, quality, design that were the essence for product development.

These environmental characteristics are endorsed by the award of the European Eco-label (also known as the Euro Flower) issued by the European Commission as approval of the product environmental status for energy saving, facilities for recycling and a host of other features. The full list of criteria and more information on the ecolabel can be found at the web-site address: <http://www.ecolabel.eu>

Recycling Information (Take-back offer)

For recycling information for our product and packaging, please contact the company corresponding to your region of residence.

For those who reside in other countries, please contact a nearest local Samsung dealer for recycling information for the products to be treated in environmentally acceptable way.

The information of Regional Takeback Schemes can be found at Samsung's web-site.

http://www.samsung.com/recycling_compliance



[For Europe only]

European consumer can find take-back information below.

Samsung UK : (<http://www.samsung.com/uk/> → About Us → Corporate citizenship → Environmental Data Corner)

Link: http://www.samsung.com/uk/aboutsamsung/samsungelectronics/corporatecitizenship/data_corner.html

CIS Only

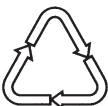
	Символ «не для пищевой продукции» применяется в соответствии с техническим регламентом Таможенного союза «О безопасности упаковки» 005/2011 и указывает на то, что упаковка данного продукта не предназначена для повторного использования и подлежит утилизации. Упаковку данного продукта запрещается использовать для хранения пищевой продукции.
	Символ «петля Мебиуса» указывает на возможность утилизации упаковки. Символ может быть дополнен обозначением материала упаковки в виде цифрового и/или буквенного обозначения.
	Символ Кедендік одақтың 005/2011 техникалық регламентіне сәйкес қолданылады және осы өнімнің қаптамасын екінші рет пайдалануға арналмағанын және жоюға жататынын көрсетеді. Осы өнімнің қаптамасын азық-түлік өнімдерін сақтау үшін пайдалануға тыйым салынады.
	Символ қаптаманы жою мүмкіндігін көрсетеді. Символ сандық код және/немесе әріп белгілері түріндегі қаптама материалының белгісімен толықтырылуы мүмкін.

低功率電波輻射性電機管理辦法

第十二條 經型式認證合格之低功率射頻電機，非經許可，公司、商號或使用者均不得擅自變更頻率、加大功率或變更原設計之特性及功能。

第十四條 低功率射頻電機之使用不得影響飛航安全及干擾合法通信；經發現有干擾現象時，應改善至無干擾時方得繼續使用。前項合法通信，指依電信法規定作業之無線電通信。低功率射頻電機須忍受合法通信或工業、科學及醫療用電波輻射性電機設備之干擾。

在5.25-5.35 兆赫頻帶內操作之無線資訊傳輸設備，限於室內使用

La operación de este equipo está sujeta a las siguientes dos condiciones:

- (1) es posible que este equipo o dispositivo no cause interferencia perjudicial y
- (2) este equipo o dispositivo debe aceptar cualquier interferencia, incluyendo la que pueda causar su operación no deseada.



BN68-04972A-09

DON'T JUST WATCH TV. DIRECTV.[®]

Save \$150[^]

A SPECIAL OFFER NOT AVAILABLE TO THE GENERAL PUBLIC!

That's an extra \$10 off every month for 15 months in addition to DIRECTV's new customer offers.

When you order the SELECT[™] Package or higher.

OTHER PACKAGES STARTING AT

\$29⁹⁹ mo.
Plus add'l fees

Everyday Low Price
FAMILY[™] Package

FREE PROFESSIONAL INSTALLATION
IN UP TO 4 ROOMS

NO EQUIPMENT TO BUY
NO START-UP COSTS

LOCAL CHANNELS
IN HD IN OVER 99% OF THE U.S.¹

All DIRECTV offers require a 24-month agreement.** Offers available through 12/31/15. Credit card required (except in MA & PA). New approved customers only (lease required). Hardware available separately. \$19.95 Handling & Delivery fee may apply. Applicable use tax adjustment may apply on the retail value of the installation. Programming, pricing and offers are subject to change and may vary in certain markets. Some offers may not be available through all channels and in select areas. See inside for details.

BUNDLE AND SAVE EVEN MORE!



Additional telco equipment and service fees apply. Eligibility based on service address. Savings amount will vary based on provider.

Plus, save up to an additional \$120^{††} when you bundle DIRECTV with Internet and phone.
With SELECT[™] Package or higher.

Save \$150 when you call this dedicated number

1-855-490-3473
or visit samsung.directv.com

DIRECTV service and offers not available outside of the U.S.

All programming and pricing valid as of November 2014. Programming, pricing and offers are subject to change and may vary in certain markets. Some offers may not be available through all channels and in select areas.

A special offer for Samsung customers.
Not available to the general public!

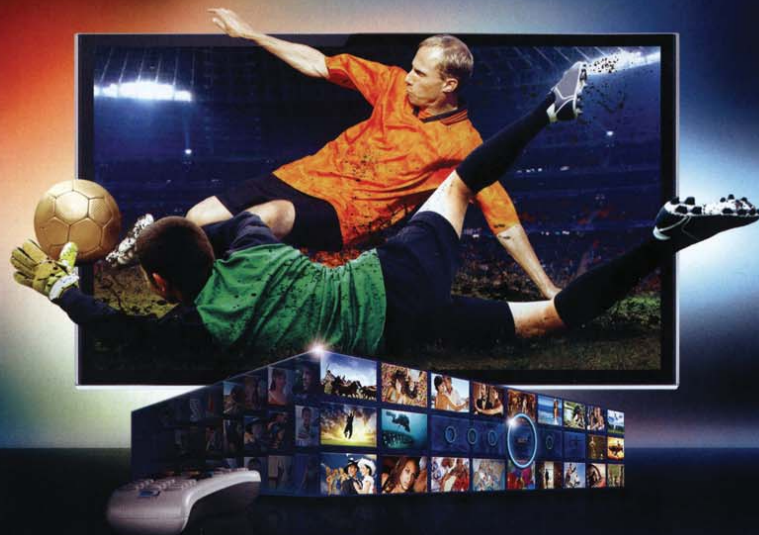

SAVE \$150[^]

in addition to DIRECTV's new customer offers.

New customers only.
Activation of the SELECT[™] Package or higher required. With 24-month agreement.**
Conditions apply. See inside for full offer details.

Save \$150 when you call this dedicated number

1-855-490-3473
or visit samsung.directv.com

DIRECTV service and offers not available outside of the U.S.



THE MOST SAVINGS.
THE MOST TELEVISION.

PACKAGES STARTING AT

\$29⁹⁹
mo.
Plus add'l fees.

Everyday Low Price
FAMILY[®] Package

FREE PROFESSIONAL
INSTALLATION
IN UP TO 4 ROOMS

NO EQUIPMENT TO BUY
NO START-UP COSTS

LOCAL CHANNELS
IN HD IN OVER 99% OF THE U.S.!

All DIRECTV offers require a 24-month agreement** Offers available through 12/31/15. Credit card required (except in MA & PA). New approved customers only (lease required). Hardware available separately. Additional fees may apply. Applicable use tax adjustment may apply on the retail value of the installation. Programming, pricing and offers are subject to change and may vary in certain markets. Some offers may not be available through all channels and in certain areas. See below for details.



The HD Channels You Want!

AMAZING PICTURE

DIRECTV delivers over 195 full-time HD channels—including local channels in over 99% of the U.S.† and the sports you really want!‡ You'll also get access to the best movies in 1080p‡ with Dolby® Digital 5.1 Surround Sound‡ for a viewing experience that redefines home entertainment! †Not all titles available in 1080p.

Plus, order now and get over 45 premium channels FREE for 3 months with the SELECT™ through ULTIMATE Packages.†



Not all premium channels available in HD.

5 Myths Busted

"My signal will go out."

Wrong. DIRECTV's high-powered satellites deliver 99% worry-free signal reliability. Based on a Nationwide Study of representative cities.

"The equipment is too expensive."

No. There's no equipment to buy and no start-up costs.

"It's too difficult to install!"

No. Our professional installer will set up all the equipment for you.

"Switching TV services is a hassle."

Not true. Upgrading is easy. Just sign up and leave the rest to us.

"I can't get local channels with DIRECTV."

Yes, you can. DIRECTV service includes local channels in over 99% of U.S. markets!



The Best Sports!

A CHAMPION FOR ALL SEASONS.

No matter what game, no matter what season, DIRECTV has you covered? No one has a better lineup of out-of-market sports packages:



Sports subscriptions sold separately.

DIRECTV Genie® and Wireless Genie Mini

Say goodbye to messy cable wires and boxes in every room. And with Wireless Genie Minis, you can connect multiple TVs wirelessly to one HD DVR; so you can put your TVs anywhere in your home—even outside!

- Never see the clutter of cable again
- DIRECTV gives you the freedom to move your TV anywhere⁴
- Connect multiple TVs wirelessly to one HD DVR
- One HD DVR powers your entire home⁵

⁵ Requires one TV connected to a Genie HD DVR and a Wireless Genie Mini for each additional TV. ⁴ Not available on the television which is connected to the Genie HD DVR. Actual range of wireless signal varies and may be affected by several factors including, but not limited to: home construction materials, obstructions, electromagnetic interference and other environmental factors. Connection of Wireless Genie Mini to TV and power source are required. ⁶ For residential use in a single household only. ⁷ Requires a Genie Mini or DIRECTV Ready TV (see below) for each additional TV. Limit three service viewings per Genie HD DVR at a time.

genie



Additional equipment required. Additional & Advanced Receiver fees apply.

DIRECTV Everywhere

Watch the same movies and shows anywhere —on your TVs at home, plus your laptop, tablet or cell phone. At no extra charge!

Limited programming available. Standard programming fees apply. Conditions apply. Details below.

YOUR MOBILE DEVICES ARE PORTABLE TVS!

Turn your tablet into a portable TV and watch your favorite channels anywhere in your home!

STREAM THOUSANDS OF TITLES AT NO EXTRA CHARGE

Instantly watch your favorite titles from networks like HBO®, STARZ®, SHOWTIME®, Nickelodeon, HGTV, A&E, Comedy Central and more—anytime, anywhere, on any device!⁸ Availability of channels varies based on programming subscription.

SMART SEARCH

enables you to search all channels, all movies, either On Demand or streaming.



All DIRECTV offers require a 24-month agreement** Offers available through 12/31/15. Credit card required (except in MA & PA). New approved customers only (lease required). Hardware available separately. Additional fees required. \$19.95 Handling & Delivery fee may apply. Applicable use tax adjustment may apply on the retail value of the installation. Programming, pricing and offers are subject to change and may vary in certain markets. Some offers may not be available through all channels and in certain areas.

SAVE \$150* when you call this dedicated number: 1-855-490-3473 or visit samsung.directv.com

When you order the SELECT™ Package or higher, 24-month agreement required.**

All programming and pricing subject to change at any time. **\$150 BILL CREDIT OFFER.** New customer must sign up using the phone number provided (1-855-490-3473) and enter a valid system ID (approved credit). Upon activation of DIRECTV System and the SELECT Package or higher, customer will receive 15 months of bill credits. Commercial accounts/customers not eligible. **WILL CANCEL PROGRAMMING OFFER 90 DAYS BEFORE END OF PROMOTIONAL PERIOD. PROMOTIONAL PERIOD CUSTOMER DOES NOT CONTACT DIRECTV TO CHANGE SERVICE THEN ALL SERVICES WILL AUTOMATICALLY CONTINUE AT THE THEN PREVAILING RATES.** Three free months of a premium movie package (including HBO, with SELECT through ULTIMATE Packages, up to 150 titles) and ONE PROGRAMMING OFFER PER ACCOUNT. Featured package/price/service and content prices. (HBO) \$29.99/mo. (SELECT) \$49.99/mo. (Advanced Receiver) \$250/mo. All pricing subject to change at any time. Account must be in "good standing" as determined by DIRECTV in its sole discretion to remain eligible for all offers. May be combined with other DIRECTV offers, including video-on-demand programs. **12-MONTH AGREEMENT. EARLY CANCELLATION WILL RESULT IN A FEE OF \$10/MONTH FOR EACH REMAINING MONTH.** Must maintain 24 consecutive months of any DIRECTV base programming package (24.99/mo. or above) or any qualifying international service bundle. Advanced Receiver fee (\$250/mo.) required for all HD DVRs. This service fee is \$250/mo. required for all HD DVRs from DIRECTV. There is a total of 16 \$250/mo. for each receiver and/or Genie HD/DIRECTV Ready TV/DVR on your account. **NON-ACTIVATION CHARGE OF \$150 PER RECEIVER MAY APPLY. ALL EQUIPMENT IS LEASED AND MUST BE RETURNED TO DIRECTV UPON CANCELLATION, OR UNRETURNED EQUIPMENT FEES APPLY. MOST DIRECTV.com/legal OR CALL 1-800-DIRECTV FOR DETAILS. INSTALLATION.** Standard professional installation up to four rooms only. Custom installation extra. **DIRECTV ON DEMAND.** Access to available DIRECTV On Demand programming is based on package selection. Actual number of shows and movies will vary. Additional fees apply for new releases. Some DIRECTV On Demand content requires an HD DVR (HDCP or later) or DVR (HDCP or later). DIRECTV CINEMA Connection Kit and broadband internet service with speeds of 7.5 Mbps or higher, and a network router with an available Ethernet port. Visit directv.com/terms for details.

1. Local channel eligibility based on service address. Not all networks available in HD in all markets. 2. Blackout restrictions and other conditions apply. Actual number of games varies by market. Professional and collegiate sports subscriptions sold separately. 3. Not all titles available in 1080p. To view programs in 1080p, the following are required: an HD DVR. Receiver (HDCP or higher), an HDMI cable connecting the receiver and the television, and a high-definition 1080p television. Not all models are compatible. 4. Dolby Digital 5.1 surround sound only available when provided by programmer. 5. Equipment available separately. 6. Only the double-D symbol are trademarks of Dolby Laboratories. 7. Effectively varies by compatible service and location. May select networks corresponding to your package selection are available for live streaming and may vary by location and device. Additional charges may apply. In-home live streaming feature requires home-based Wi-Fi connection and internet-connected HD DVR. Out-of-home viewing requires high-speed internet connection. All functions and programming subject to change at any time. Visit directv.com/where and directv.com/apps for a list of compatible devices (sold separately) and compatible devices. (See change fee apply) **UP TO \$150 SAVINGS OFFER.** DIRECTV customers who activate for currently subscribe to television services with SELECT Package or above and add qualifying service(s) from a preferred provider will automatically receive the following bill credits on their DIRECTV bill when services are ordered through DIRECTV: \$150/mo. bill credit for 12 months (120 mo.) for TV credits with select providers with activation of High-Speed Internet and phone service. All accounts must remain in "good standing" as determined by DIRECTV in its sole discretion, or bill credits will cease. High-Speed Internet and phone subject to availability, service not available in all areas. Eligibility based on service address and phone line. Internet and/or phone service provided by preferred DIRECTV provider and billed separately. Prices may vary depending on provider and are subject to change. Separate agreement for internet installation may be required. Equipment may be required and sold separately. Start-up costs, taxes and other fees may apply. Complete system requirements vary by provider. Terms and conditions for selected internet service provider apply. DIRECTV television service contract required. **To access DIRECTV HD programming.** HD equipment is required. Number and type of HD channels varies by package selected. Programming, pricing, terms and conditions subject to change at any time. Pricing residential. Taxes not included. Receipt of DIRECTV programming subject to DIRECTV Customer Agreement, copy provided at directv.com/legal and in order confirmation. HD, the HD, Shield design and the HD, SHIELD, XBOX, and logo are registered trademarks of the HD, and the Shield. ©2015 DIRECTV, DIRECTV and the Cyber Group logo, GENIE, DIRECTV SELECT and DIRECTV READY TV, DIRECTV are trademarks of DIRECTV, LLC. All other trademarks and service marks are the property of their respective owners. HBO®, Cinemax® and related channels and service marks are the property of Home Box Office, Inc. STARZ® and related channels and service marks are the property of Starz Entertainment LLC. SHOWTIME® and related marks are trademarks of Showtime Networks Inc., a CBS Company.